

CHOWIS

YOUR CHOICE OF DIAGNOSIS



DS Harris Dermosmart

Dermobella Hair 2 EVO

Full Manual

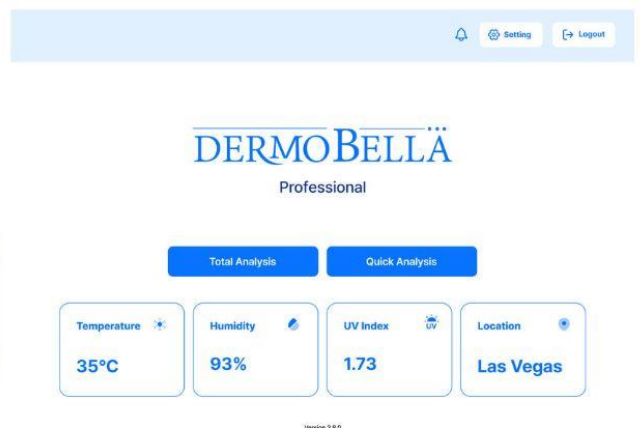

DERMO BELLÄ

HAIR 2 EVO

For more information visit us at www.chowis.com

CONTENTS

- **DEVICE OVERVIEW**..... i
- **PACKAGE INCLUSION**..... i
- **SAFETY PRECAUTIONS**.....ii
- **CHARGING**.....iii-iv
- **HOW TO INSTALL**..... 1
- **HOW TO SIGNUP** 2
 - Sign Up Account..... 2
- **HOW TO LOGIN**..... 3
 - Account Login..... 3
 - Device Activation 3
 - Forgot Password..... 4
 - Register the SSID of Analyzer.....5-6
- **ANALYSIS FLOW** 7
 - Select Mode of Diagnosis..... 7
 - Total Analysis..... 8
 - New Customer 8
 - Device Connection..... 9
 - Try Demo Analysis..... 10
 - Quick Analysis..... 11
 - Select Program. 12-13
 - Total Program..... 14
 - Hair Loss.....15
 - Scalp Sebum.....16
 - Hair Shine.....15-16
 - Hair Density.17
 - Dead Skin Cells.....17

CONTENTS

- Sensitivity17
 - Hair Thickness18
 - Other Function.....19
 - Delete and Analyze.....19
 - Analysis..... 19
 - Analyze..... 19
 - Questionnaire19
- **RESULTS.....20**
 - Analysis Results Review 20
 - Hair Loss Results.....20
 - Scalp Sebum.....21
 - Shine Algo/Hair Shine.....21
 - Hair Density Results.....22
 - Dead Skin Cells.....23
 - Sensitivity Results.....24
 - Hair Thickness Results.....25
 - Overall Results.....26
 - Spider Graph. 26
 - Analyzed Images.....26
 - Bar Graph.....27
 - Comments Section. 28
 - Share Results. 28
 - Uploading of Data to Cloud..... 28
- **CUSTOMER MANAGEMENT.....29**
 - Manage Customer 29
- **VIEW RECORD.....30**

CONTENTS

- Compare Analysis Records..... 30
- View Images..... 31
- Previous Analysis Results..... 32
- **SETTINGS**..... 33
 - General Settings..... 33
 - General Options33-34
 - Camera Settings..... 35
 - Add/Remove Device.....35
 - WI-FI Frequency. 36
 - Router Settings..... 37
 - AP Mode 37
 - Direct Mode (Reset). 38
 - Product Recommendation..... 39
 - Personalized Program. 40
 - Language Settings..... 41
 - User Profile..... 42
 - Change Password..... 42
 - Reset ID 43
 - Data Synchronization 44
 - License Management 45
- **FAQ**. **46-47**
- **APPENDIX**:.....**48**
 - Proper Image Capturing..... 48
 - Example of Correct and Incorrect images. 49
- **SPECIFICATION** **50**
 - Contact. 50

DEVICE OVERVIEW & PACKAGE INCLUSIONS

DEVICE OVERVIEW

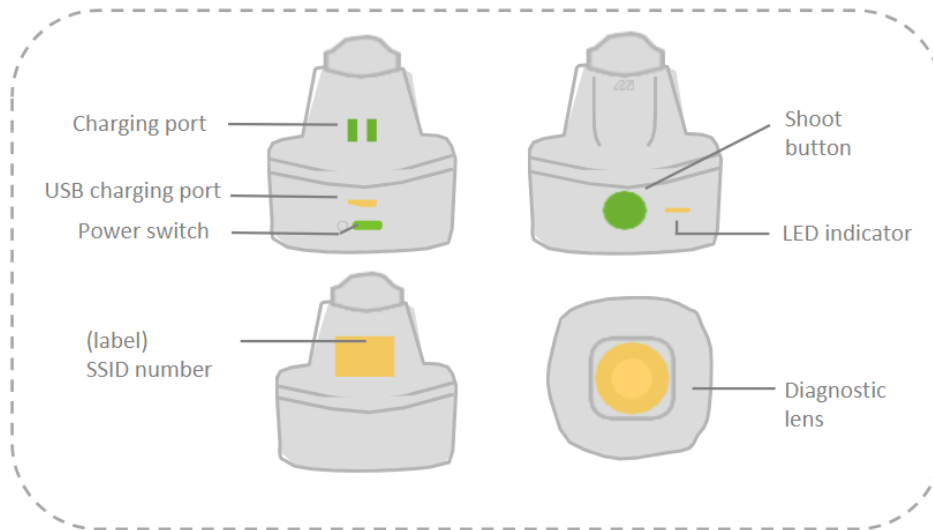

PACKAGE INCLUSIONS



dsHarris



dsHarris User Manual



Micro – USB Cable

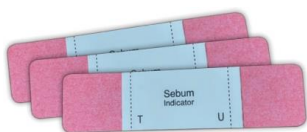

Sebum Paper -2 pack
50 pieces per pack



Cleaning Cloth



QR CODE sticker

SAFETY PRECAUTIONS

Please make sure to read these instructions in the manual carefully before using the device for safety and proper use.

Do NOT touch or insert any items into the optical unit/lens.

Putting foreign substances inside the optical unit or touching the inner part of the lens can affect image quality causing the images to become blurred or unclear. In case there is dust on the lens, use the provided air blower to remove it. Also, do NOT put fingers or hands or other substances into the optical unit/lens. Potential damage can occur to the handset if attempted.

Do NOT look directly into the light of the optical unit.

The optical unit has multiple LEDs which can emit high brightness. Do not look into the light directly to prevent damaging the eyesight.

In case the handset feels hot to touch, temporarily stop using the handset.

When the handset is turned on for long hours or is being charged, the temperature of the handset may increase. If this is the case, then briefly turn the power off and stop using the handset until it cools down.

You must only use the provided accessories with the device.

Accessories and chargers are provided along with the device set. Make sure to only use them to secure compatibility and safety. Using unauthorized accessories may affect the performance and cause breakdown. In this case, the warranty cannot be applied, and you cannot receive any guaranteed service.

Do NOT use the handset while charging.

The USB charger (separate purchase available) can cause static in case the handset is used while being charged. It can also affect the analysis result. Therefore, please refrain from using the handset while charging.

Do NOT let conductive materials/substances come into contact with the charger socket or the sensor of the handset.

Do NOT let conductive material (scrap metal, lead etc.) come into contact or get inside of the sensor or the charger socket of the handset. If something seems wrong, stop using the handset and inquire at the retailer or customer support center.

Use the device at temperatures between 5c° ~ 40c°.

Proper storage is required for the device. Potential damage can occur on the handset such as errors or abnormal battery discharge in case the handset is used or stored in too hot or too cold places.

Place the device in a dry location, away from moisture or humidity.

Do NOT touch the device with wet hands or use it in a humid environment.

SAFETY PRECAUTIONS

Refrain from using the device during periods of severe weather which include thunder and/or lightning.

Please refrain from using the device and unplug the power under severe thunder and lightning. A lightning strike can cause damage or breakdown of the device. Also, please be careful not to get it in contact with material with electric current.

Do not disassemble the handset

Do not disassemble the handset. It will have an impact to the entire Diagnosis System and the warranty will not be applied and it will be voided automatically. Additionally, if any components, such as the battery or PCB are changed without prior consultation from Chowis office, accurate diagnosis might not be possible.

Do not clean the handset with any chemical substances.

Do not wash or clean the handset with any chemical substances such as alcohol, benzene, thinner, detergent etc. It can cause damage or breakdown to the handset.

The handset may cause interference with other handsets

CHARGING

- LED Indicator on the backside of device, will display the Battery Level.



- When the device is **on** and connected to the charging cable, the Last LED will blink with red indicating device charging successfully. When the device is **off** and connected to the charging cable, the indicator will turn to red indicating device charging successfully



Red light blinks even if the device is turned off.

- The diagnostic device takes round 2-3 hours to charge fully and can be used for about 3 to 4 hours continuously after a full charge.

SAFETY PRECAUTIONS

- **Frequent Usage:**

For frequent use, extend the sleep mode on the diagnostic device to avoid reconnecting to Wi-Fi every time you use it. Periodically check that the device stays charged.

- **Infrequent usage**

1. When continuous charging is possible:

Use the diagnostic device without any conditions. But if you prefer not to keep it on all the time, turning it off after use is recommended, even if it means waiting 30-60 seconds to reconnect before the next use.

2. When continuous charging is not possible:

If continuous charging isn't an option, especially on mobile or when a charger is not nearby, it's recommended to turn off the diagnostic device immediately after use.

Continuous Charging: Keep the device cradle plugged in to ensure it remains charged at all times.

- **Turning on the Analyzer**

1. Hold the power button for 6 seconds.
2. The LED indicator will blink blue initially.
3. The LED will turn green, indicating the analyzer is ready to use.

- **Turning off the Analyzer**

1. Hold the power button for 6 seconds.
2. The green LED light will turn off.
3. Release the button.

HOW TO INSTALL

APP INSTALLTION

1. Launch Google Play Store or Appstore and search "Chowis" or "Dermobella Hair 2 EVO"

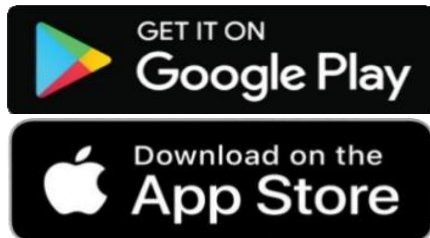

2. Select '**Dermobella Hair 2 Evo**' and press 'Install' to proceed.

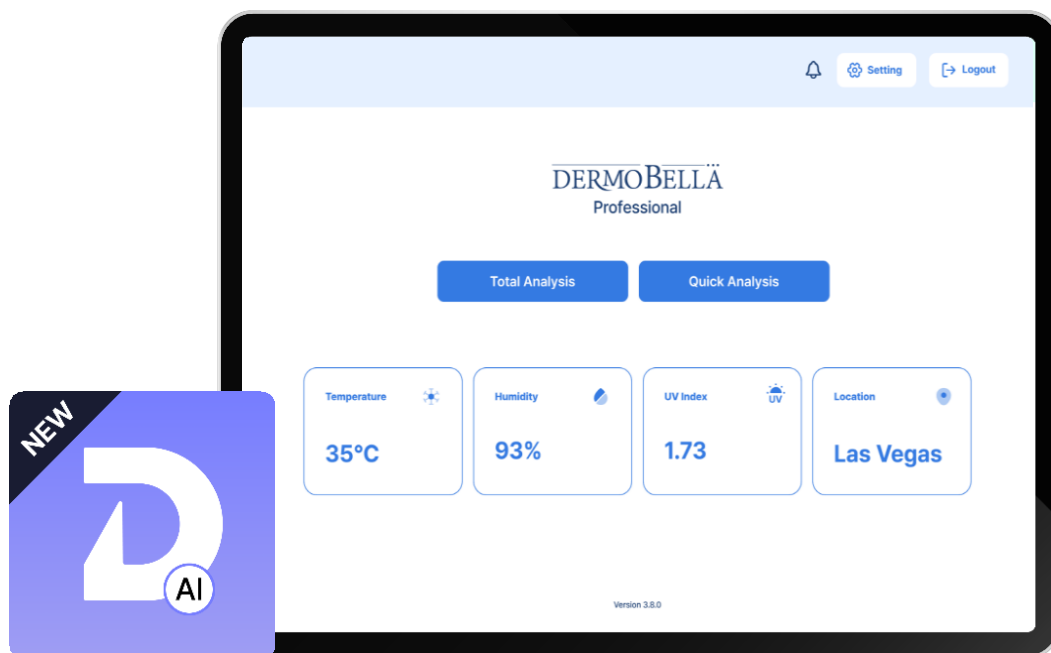

HOW TO SIGN UP

HOW TO SIGN UP

1. Open the “**DermoBella Hair 2 EVO**” app
2. Tap “**Sign Up**” to create an account.

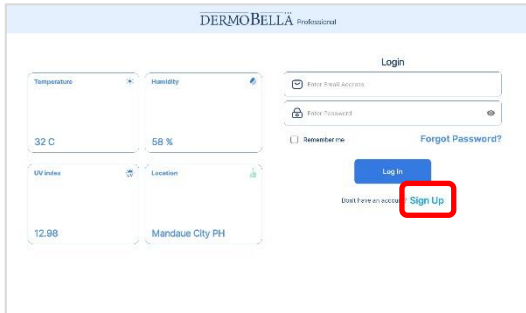

3. Type the e-mail address and password you want to use, and accept the required terms and conditions, then click the “**Sign Up**” button.

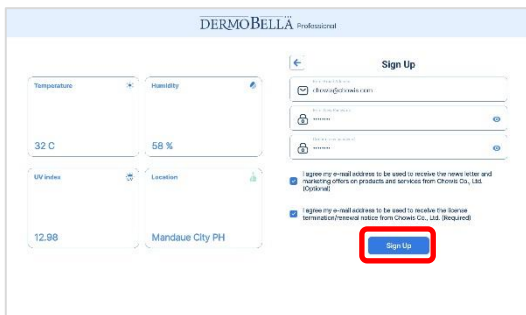

4. Once registration is successful, a verification email will be sent to your registered email address. 5. Open email from **CHOWIS SERVICE** and click the “**CONFIRM**” button to proceed.

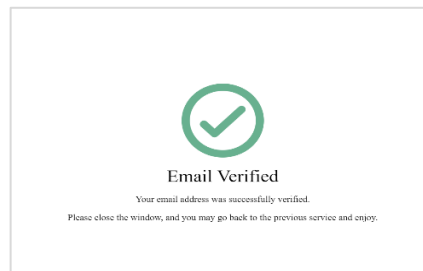
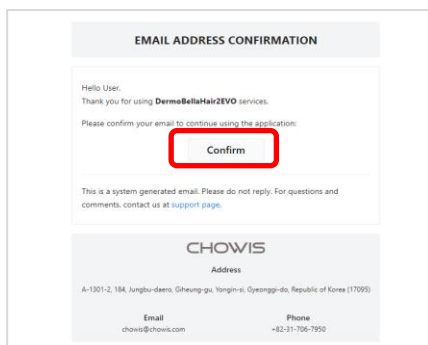

HOW TO LOGIN

ACCOUNT LOG IN

1. Open **DermoBella Hair 2** app.
2. Login to your account and tap the **"Login"** button to log in to the app, then tap the **"Proceed"** button to continue.

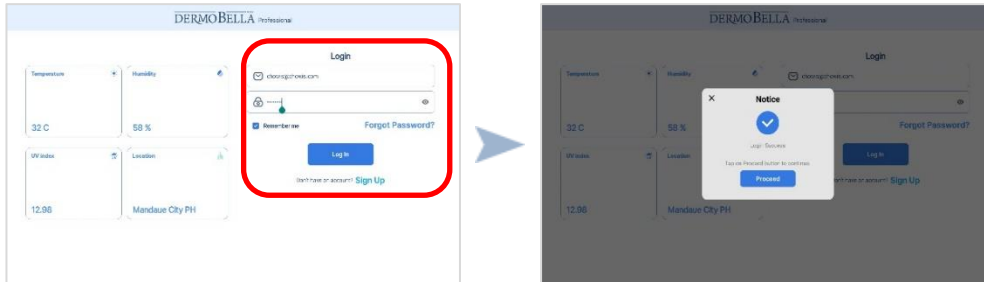

DEVICE ACTIVATION

1. After the Login is successful, scan the Device QR code or the Paper QR Code to activate the device. This will scan the optic number and register the Wi-Fi no. (SSID no.)



2. Or you can press "Manual Input" to manually input the Optic Number and Wi-Fi no. (SSID no.) of the device and press **"Activate"**.



HOW TO LOGIN

FORGOT PASSWORD

1. Open **DermoBella Hair 2** app.
2. Tap the **"Forgot Password?"** and type the recovery email address, then tap the **"Forgot Password"** button.

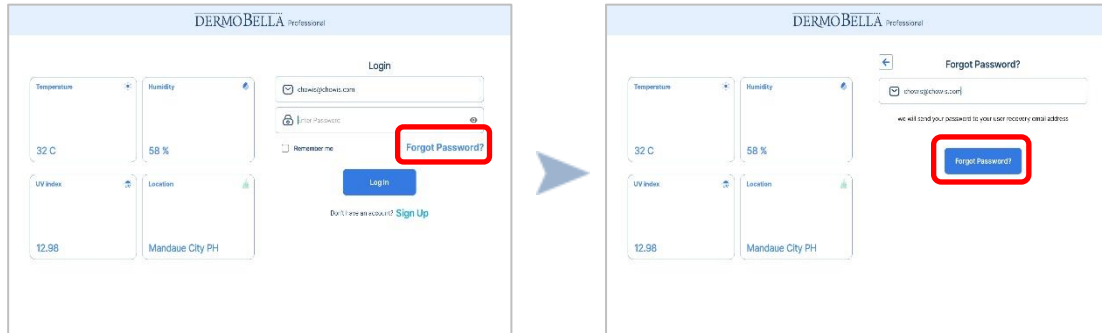

3. A new password will be sent to your email address.

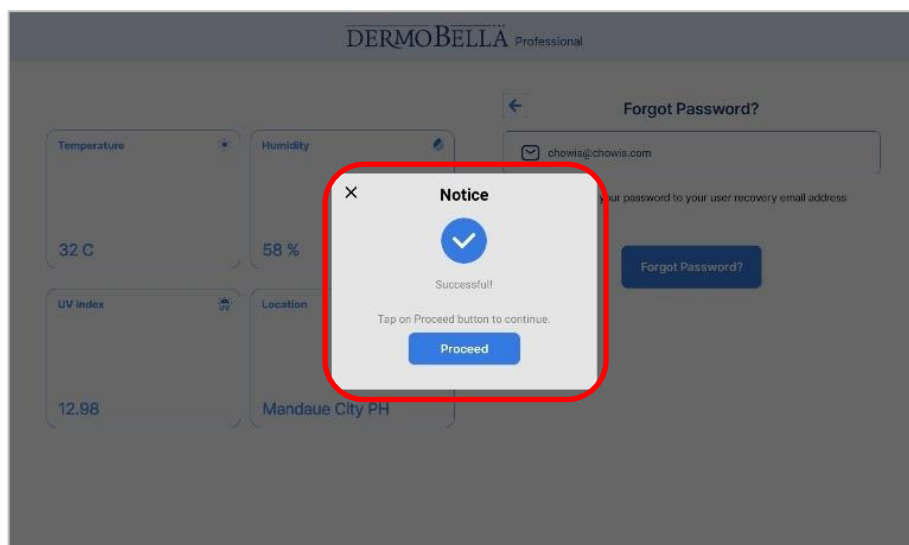

REGISTER THE OPTIC No. & SSID No.

INITIAL SETTING

1. Login to the Dermobella application.
2. Click on "Settings".

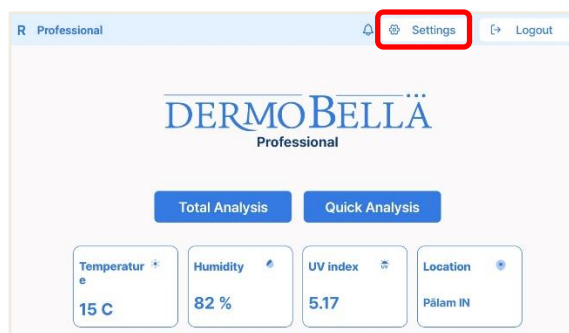

3. Go to "Camera Settings".

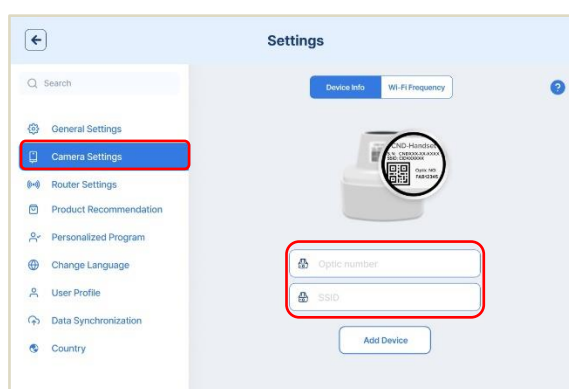

4. Scan the QR code. **The optic no. and Wi-Fi no. (SSID no.)** will be registered.

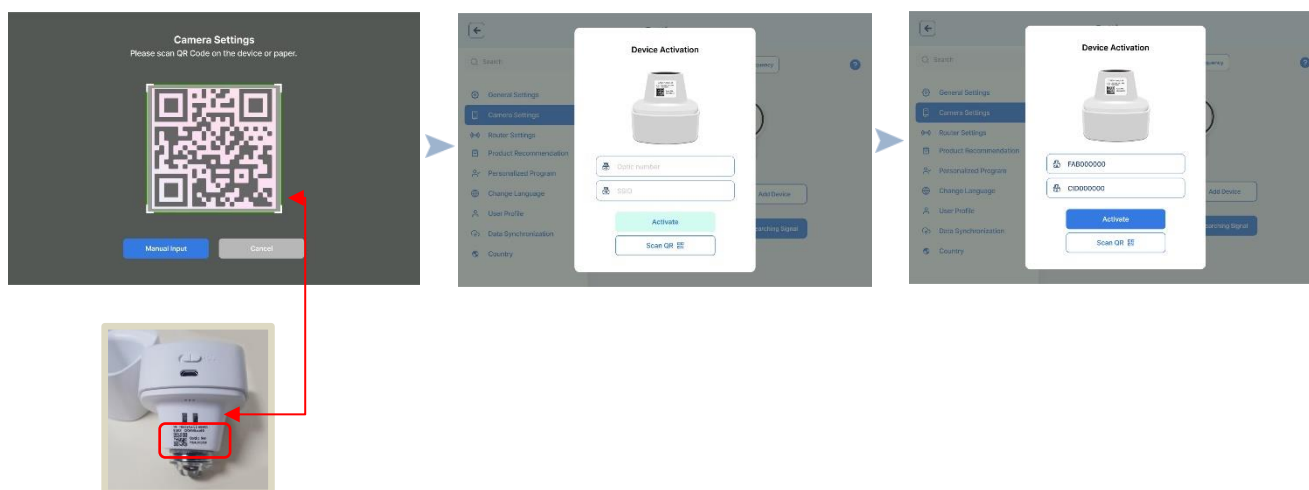

REGISTER THE OPTIC No. & SSID No.

5. You can manually also enter the **optic no. and Wi-Fi no. (SSID no.)**.

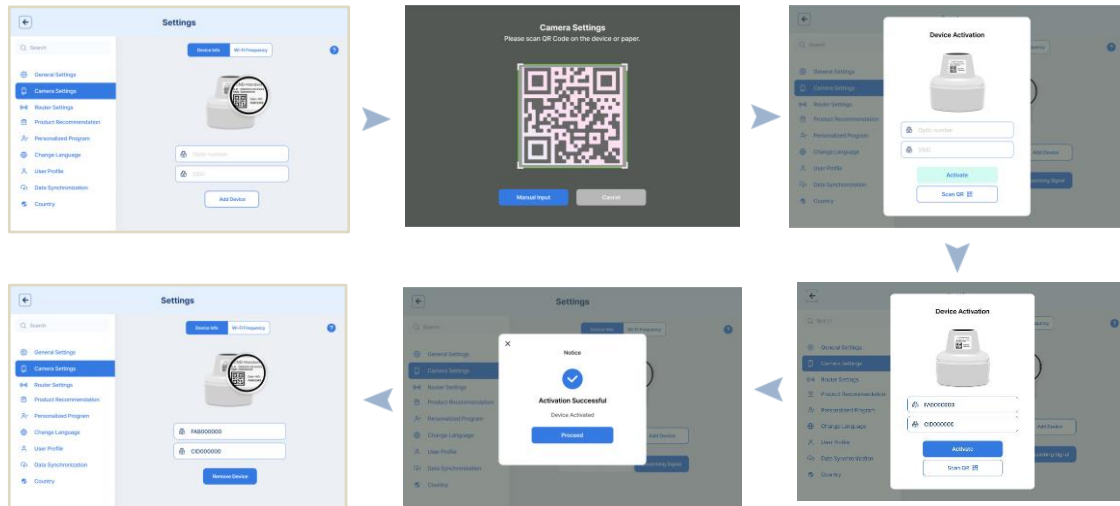

Note:

- The device is turned on.
- **Connection Indicator:** If the analyzer successfully connects to the tablet, the LED light will turn blue.

ANALYSIS FLOW

SELECT MODE OF ANALYSIS

The analysis can be performed in one of two modes: '**Total Analysis**' and '**Quick Analysis**' mode

- TOTAL ANALYSIS

When selected, this option allows you to input specific details of the customer to register including name, age, and gender, and save all information for the next and succeeding analysis sessions.

- QUICK ANALYSIS

Quick Analysis is an option without specific customer registration. The diagnosis process is the same as total diagnosis, but customer data management is not available and data will not be saved including images and results.

- TRY DEMO

Test the image capture and analysis flow without customer registration or viewing results.

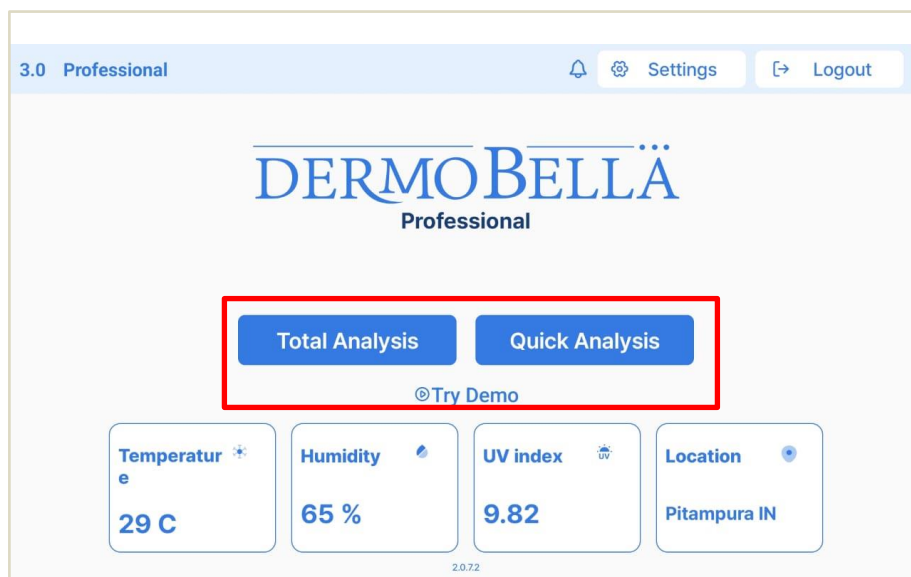

ANALYSIS FLOW

TOTAL ANALYSIS

- New Customer Registration

1. Press **TOTAL ANALYSIS** from the main screen and select **NEW CUSTOMER**.

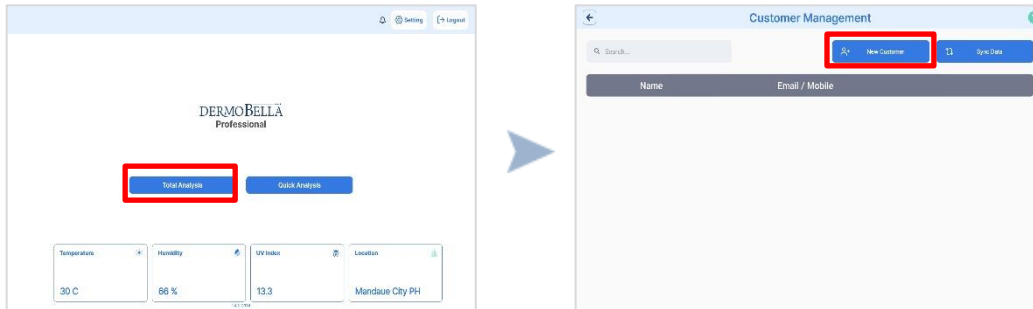

2. Fill in all the required fields marked with (*). After completing the form, check and agree to the "Personal Information Policy" and "Data Transfer" at the bottom and press the **"Register"** button.

The 'Customer Registration' form contains the following fields and options:

- Name (*)
- Surname (*)
- Country
- Z.C.
- Address
- *Entering mobile phone or email is required.
- Mobile: KR +82 (*)
- E-mail
- Date of Birth (*)
- Ethnicity (*)
- Gender: Male (*) and Female (*)
- I agree to the [Privacy Policy](#) (*)
- I agree to the [Transfer Data](#) (*)
- Register (highlighted with a red box)

ANALYSIS FLOW

TOTAL ANALYSIS

DEVICE CONNECTION (Device Mode)

1. Before Selecting a program when starting the diagnosis, a pop-up will appear asking you to connect with the device in case of saved SSID No. (Wi-Fi no.).
2. Press 'Connect' to proceed with the connection.
3. For iOS devices, simply press "Connect" to enable the analysis program.

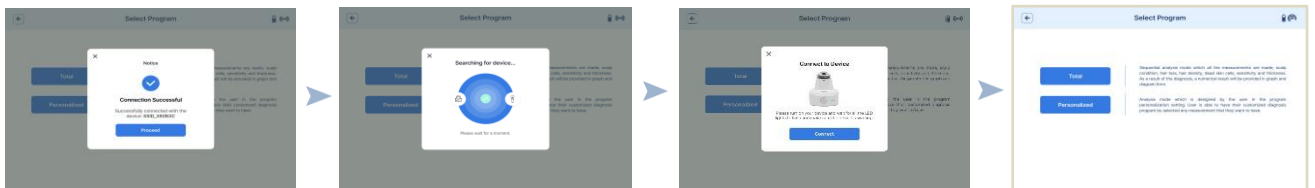

4. For Android devices, a Wi-Fi list will appear at the bottom of the screen for first-time users. Select the device SSID (Wi-Fi no.) and enter the password: 1234567890.

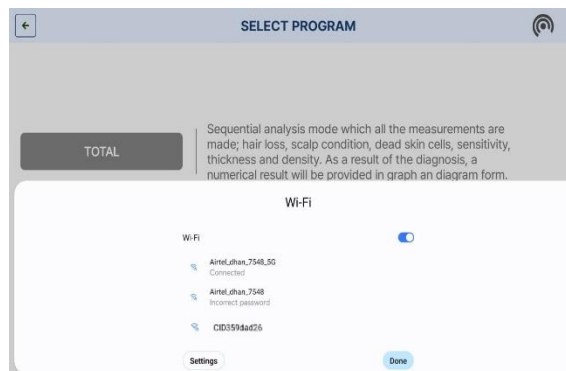

ANALYSIS FLOW

TRY DEMO ANALYSIS

Try Demo : Guidelines for the Test Analysis

- Click Try Demo on the main page, then Connect to the device's SSID (Wifi-no.).
- The demo flow will start—click to proceed, and the skin group detection page will appear.
- Place the analyzer on the skin, capture, and confirm to start measurement.
- You can adjust it if needed, then click confirm to start capturing measurements.
- Capture one image for each measurement, and the analyzed image will be displayed afterward.

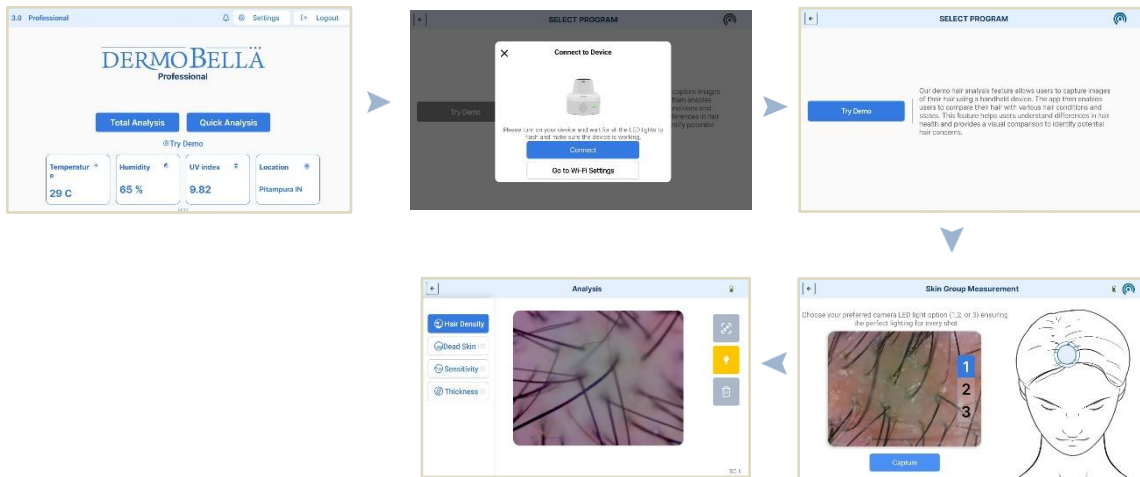

- Use the compare icon to compare captured images with the database images, or delete if needed.

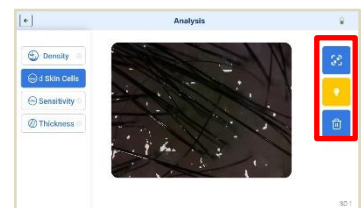

ANALYSIS FLOW

QUICK ANALYSIS

The Quick Analysis is an option without specific customer registration. The diagnosis process is the same as Total Analysis, but customer data management is unavailable. By using this option, no data such as results and images will be saved.

1. In Auto + Manual Mode (default), click "**Quick Analysis.**"

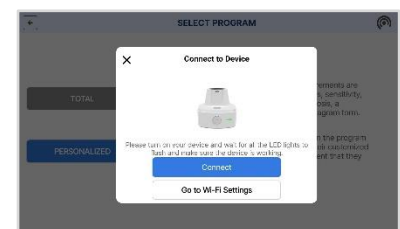
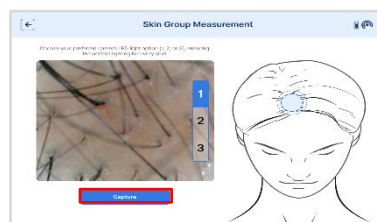
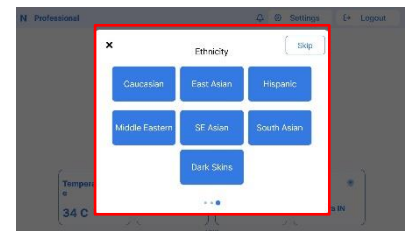
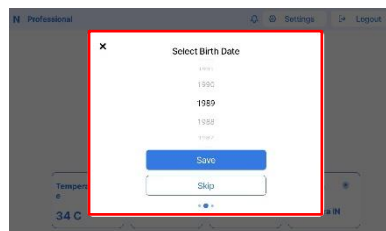
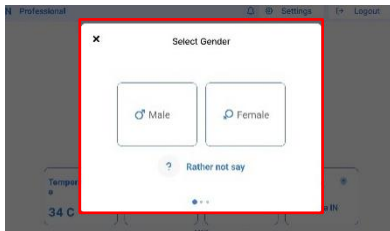

2. You'll be asked to enter Gender, Birth Date, and Ethnicity; these fields are optional.
3. Select the appropriate LED light option (1, 2, or 3) for Skin Groups 1-6.
4. Place the lens on the front of the scalp.
5. Capture the image to detect the skin group.

ANALYSIS FLOW

SELECT PROGRAM:

- Total Program

1. After adding the customer record, select the program by clicking on "**Total Analysis.**"
2. A window will open to detect the skin group for further steps.
3. Select the LED light mode setting under "Auto + Manual," the default mode.
4. LED Light option 1: For Skin Groups 1 and 2.
5. LED Light option 2: For Skin Groups 2 and 3.
6. LED Light option 3: For Skin Groups 4 and 5.
7. Place the lens on the **front area of the scalp** and capture the image for accurate skin group detection.
8. The skin group will be assigned automatically; you can change it later in CRM if needed.
9. Once done, you'll be on the Analysis Page to capture images for all measurements.

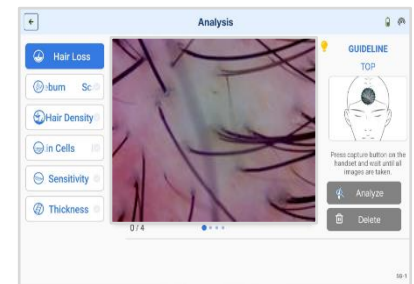
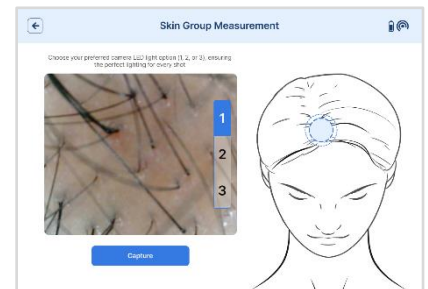
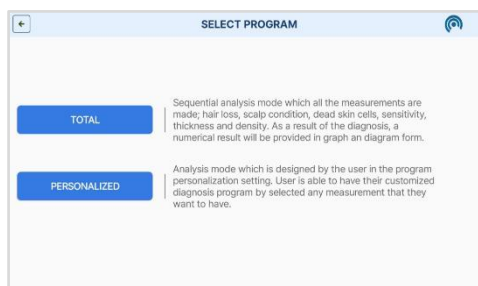
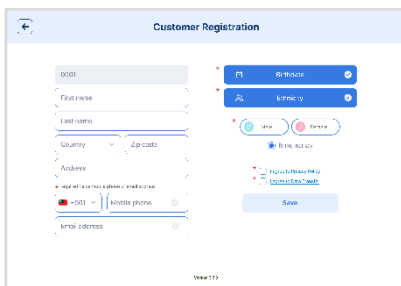

ANALYSIS FLOW

- Personalized Program

Analysis mode which is designed by the user in the program personalization setting. User can have their customized diagnosis programs by selecting any measurement that they want to have in the app to proceed with the diagnosis in order.

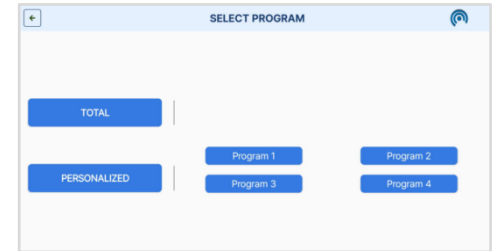
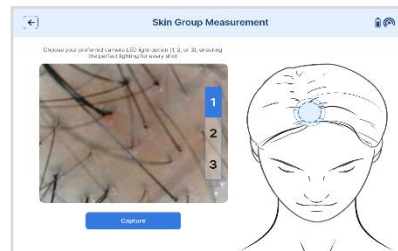
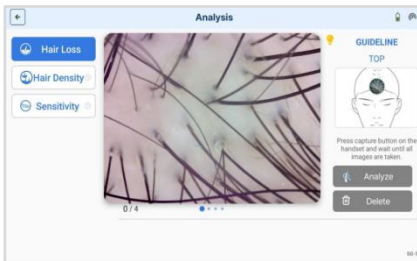
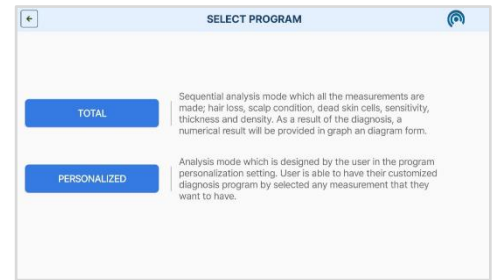
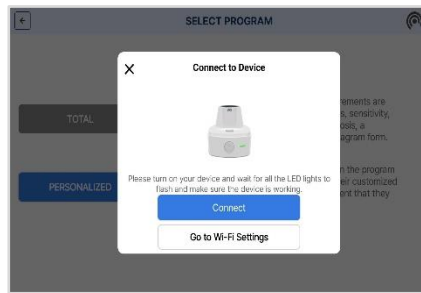
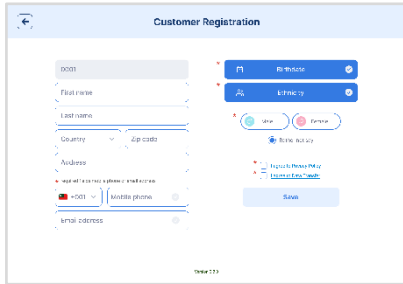

ANALYSIS FLOW

TOTAL PROGRAM:

- HAIR LOSS

1. For accurate diagnosis, place the diagnostic device in the same position as guided by the guidelines and proceed with the shooting.

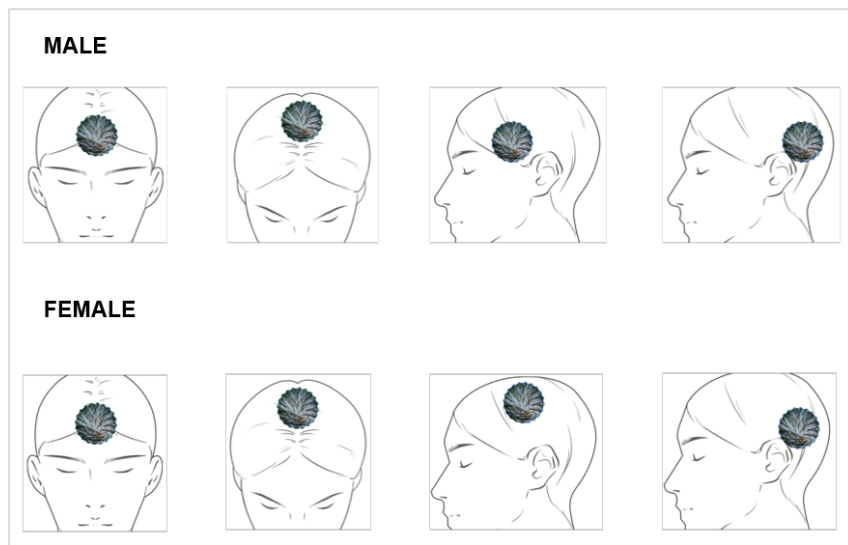
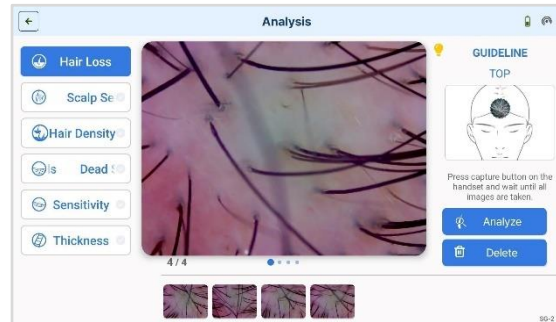

2. When shooting, part the hair so that the scalp can be clearly seen, and place the lens of the diagnostic device close to the shooting area

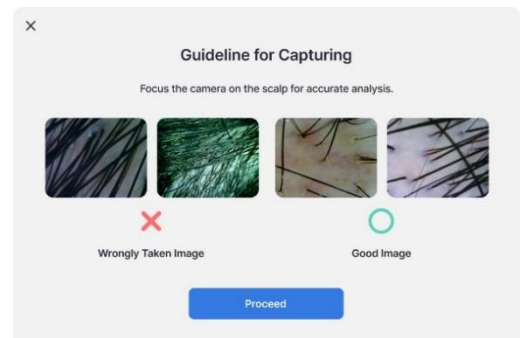

3. Press the shoot button and wait for the image to be taken correctly.

NOTE: Make sure that the guide has been followed and ensure that all 4 images are captured prior to moving to next measurement

ANALYSIS FLOW

TOTAL PROGRAM

Continue to take pictures by categories. Multiple photos can be taken and saved for each category as shown at the bottom of the screen.

NOTE: 5 is the maximum number of images that can be taken per measurement.

- SCALP SEBUM

1. Follow the guidelines on the application to take the measurement.
2. Place the sebum indicator's pink part on the front area of the scalp for 3 seconds.
3. Capture the sebum paper image, ensuring only the pink area is included.
4. Then, place the same sebum paper to the crown area of the scalp and capture the image.

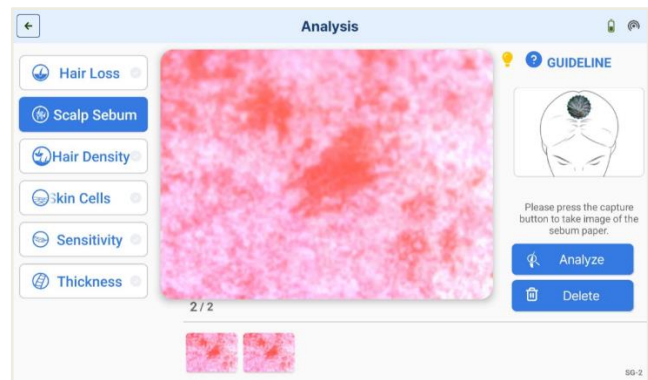
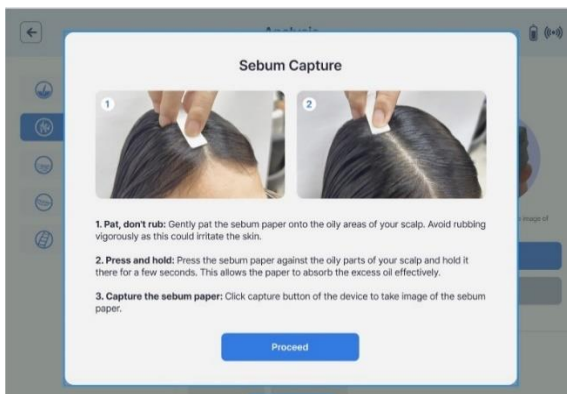

- SHINE ALGO

1. The app is initially set to measure Scalp Sebum by default.
2. If the consultant doesn't have sebum paper, they can go to **General Settings** and under **"Scalp Condition Mode"** select **"Shine Algo"** for the scalp condition instead.
3. After selecting the mode, click on "Save Changes."

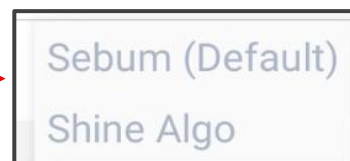
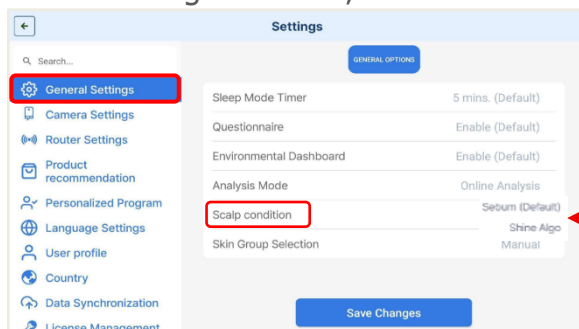

***Note:** Chowis team recommends to use sebum indicator for measurement, for more accurate result

ANALYSIS FLOW

TOTAL PROGRAM

- HAIR SHINE

1. Select "**HAIR SHINE**" from the left side.
2. Place the handset flatly on your parted hair with clear view of the scalp.
3. Once ready, press the "**CAPTURE**" button of the handset.

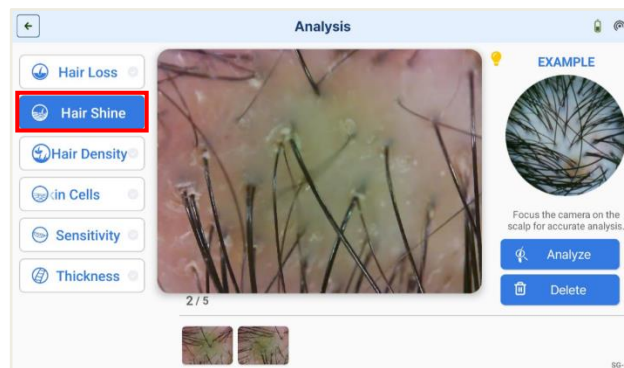

- HAIR DENSITY

1. Select "**HAIR DENSITY**" from the left side.
2. Place the handset flatly on your parted hair with clear view of the scalp.
3. Once ready, press the "**CAPTURE**" button of the handset.

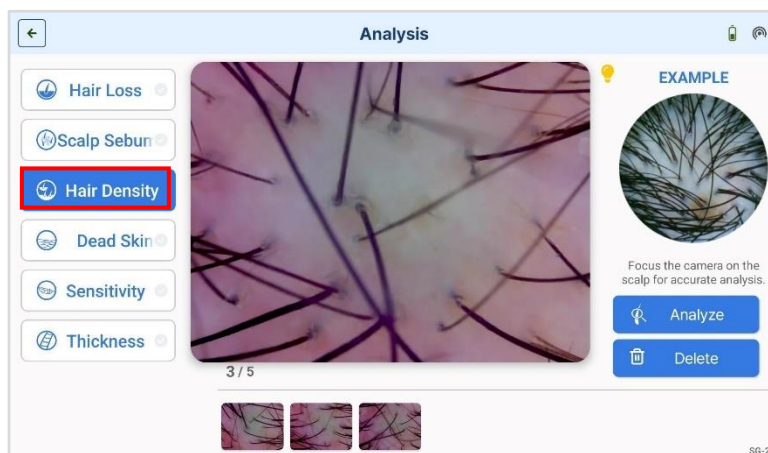

Move to the next measurement on the left side when done.

ANALYSIS FLOW

TOTAL PROGRAM

DEAD SKIN CELLS

1. Select "DEAD SKIN CELLS" from the left side.
2. Place the handset flatly on your parted hair with clear view of the scalp.
3. Once ready, press the "CAPTURE" button of the handset

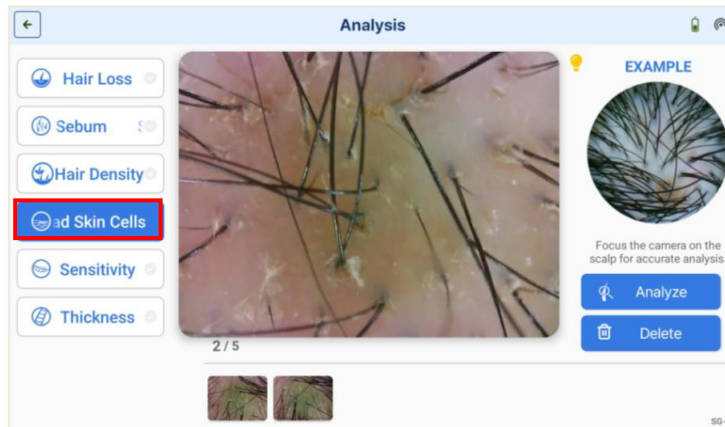

Move to the next measurement on the left side when done.

SCALP SENSITIVITY

1. Select "SENSITIVITY" from the left side.
2. Place the handset flatly on your parted hair with clear view of the scalp
3. Once ready, press the "CAPTURE" button of the handset

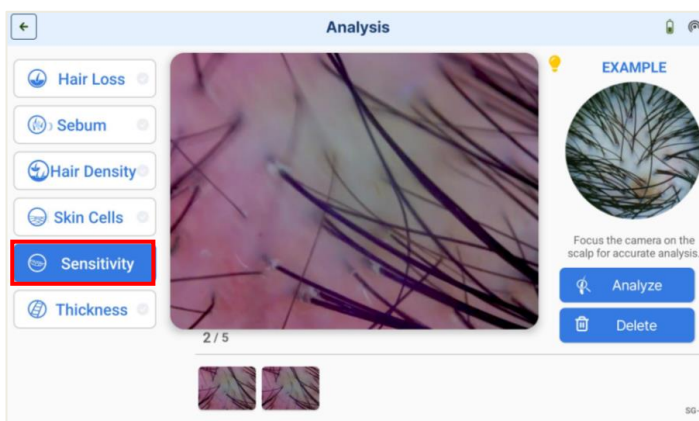

Move to the next measurement on the left side when done.

ANALYSIS FLOW

TOTAL PROGRAM

- HAIR THICKNESS

1. Select "THICKNESS" from the left side
2. Place the handset flatly on your parted hair with clear view of the scalp
3. Once ready, press the "CAPTURE" button of the handset.

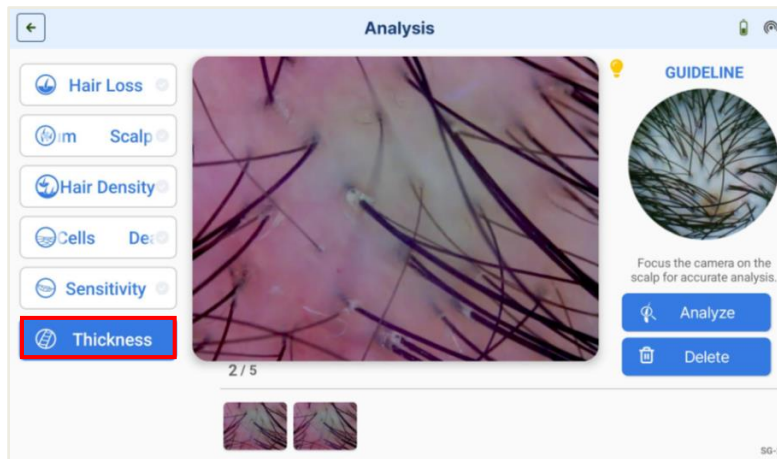

- OTHER FUNCTION

1. **DELETE:** Select the image you want to delete. Selected images will show on the screen and then press the "**DELETE**" button
2. After taking all the images you want from all the hair parameters click "**ANALYZE**" on the right side of the app. (Note: once analyze process has been selected, you cannot go back to Analysis page (the image capture page))

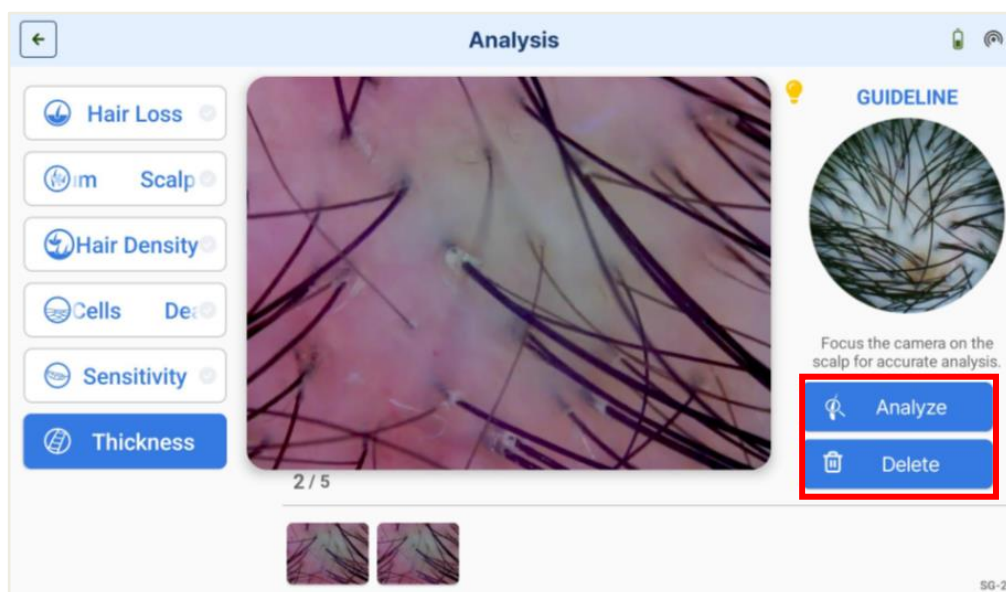

ANALYSIS FLOW

TOTAL PROGRAM

- ANALYSIS

1. After all images are captured, press on **"Analyze"** to allow system to analyze all images captures for each measurement.

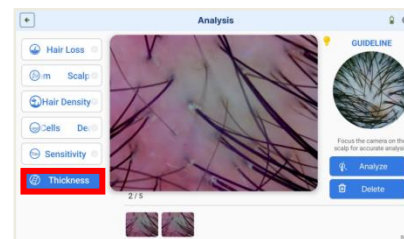

2. After analysis of images is done, a Questionnaire Page will display on the app. Skipping the questions to proceed with diagnosis is possible by pressing **"Skip Questionnaire"** button on the bottom of the page.

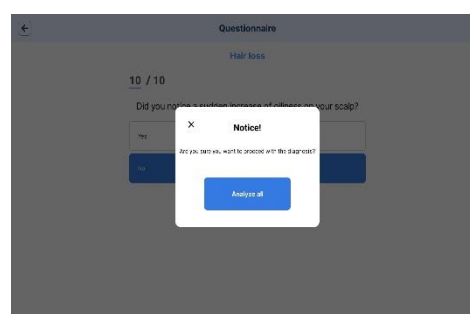
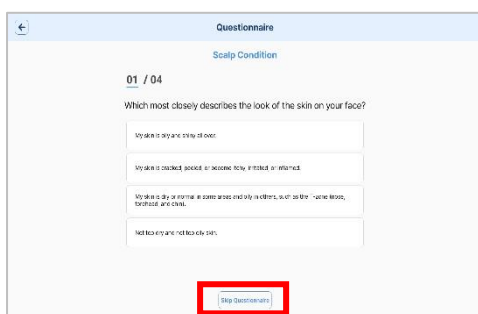

3. It may take few seconds for each image to analyze but once the progress bar reaches 100%, it means that the analysis is already completed.

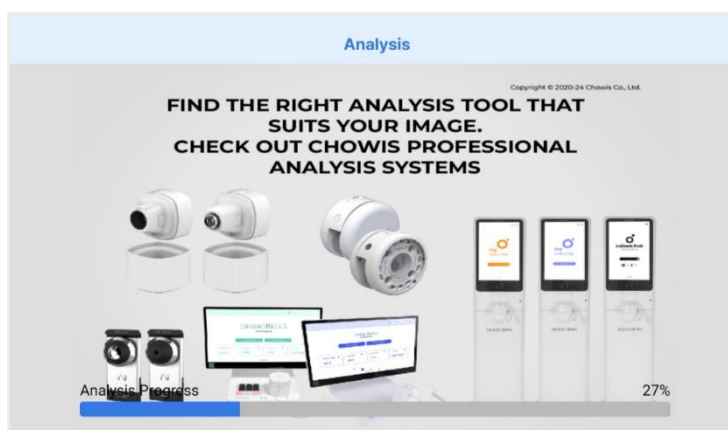

NOTE: Please note that if you choose to "SKIP QUESTIONNAIRE," the analysis will solely rely on the captured images and will not incorporate the results from the questionnaire.

RESULTS

ANALYSIS RESULTS REVIEW

- HAIR LOSS RESULTS

The following CHOWIS hair loss grade has been co-developed by CHOWIS and dermatology experts. As recommended by experts, we require 4 images taken at signature scalp positions shown in figure 1. For each image, first our advanced AI detects hair follicles and the number of hairs in each follicle. The average number of hairs per square centimeter is then calculated as the hair density score for that image. An expert approved questionnaire is also included, as an option, in order to understand a customer’s lifestyle and habits and obtain a fuller profile of the customer’s hair. Taking into account the questionnaire results, the final Overall Result for hair loss is computed as the weighted Average of all image scores and questionnaire score. In case that questionnaire is skipped, only image detection results will be used to calculate the Average. Based on the scale provided in table 1 we grade the hair loss level as none, beginning stage, middle stage, and last stage.

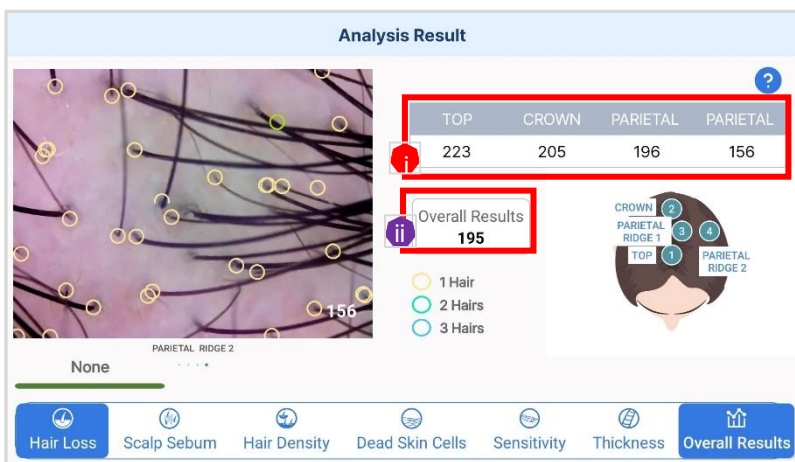

- i Results indicate individual image score
- i The Overall result represents the average of captured images under a specific hair parameter

Grade for Hair loss	Scale	Description
None	180+	No significant hair loss
Beginning stage	152 ~ 180	Mild stage of hair loss: perceptible thinning of hair, earliest stage of hair loss
Middle stage	106 ~ 151	Moderate stage of hair loss: pronounced decrease in hair density
Last stage	0 ~ 105	Severe stage of hair loss: pronounced rarefaction of hair, more significant than previous stage

RESULTS

- SCALP SEBUM RESULTS

The following CHOWIS scalp sebum grade has been co-developed by CHOWIS and dermatology experts. As recommended by experts, we require 2 images taken in the front and crown areas of scalp. For each image, we detect sebum and calculate scalp sebum to provide a quantified score. An expert approved questionnaire is also included, as an option, in order to understand a customer's lifestyle and habits and obtain a fuller profile of the customer's hair & scalp. Taking into account the questionnaire results, the final Overall Result for scalp sebum is computed as the weighted Average of all image scores and questionnaire score. In case that questionnaire is skipped, only image detection results will be used to calculate the Average. Scores range from 0 to 99, with higher scores indicating more scalp sebum and lower scores indicating less. Scalp sebum levels are graded as clear, almost clear, mild, moderate, and severe.

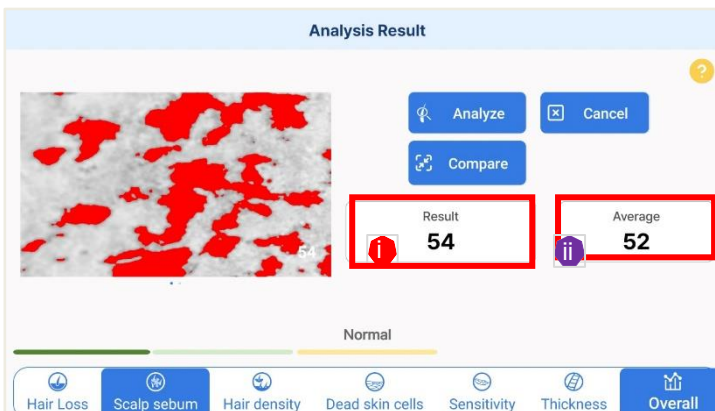

- i** Results indicate individual image score
- ii** The Average Score may differ from Results as it represents the overall captured images under a specific hair parameter.

- HAIR SHINE RESULTS

To obtain the Hair Shine grade, we first detect hair and calculate hair shine to provide a quantified Result score for each image. Then we compute the final score for hair shine as the Average of all result score. Scores ranging from 0 to 99 correlate with hair shine; higher scores indicate more shine, while lower scores signify less shine. We grade hair shine as clear, almost clear, mild, moderate, and severe.

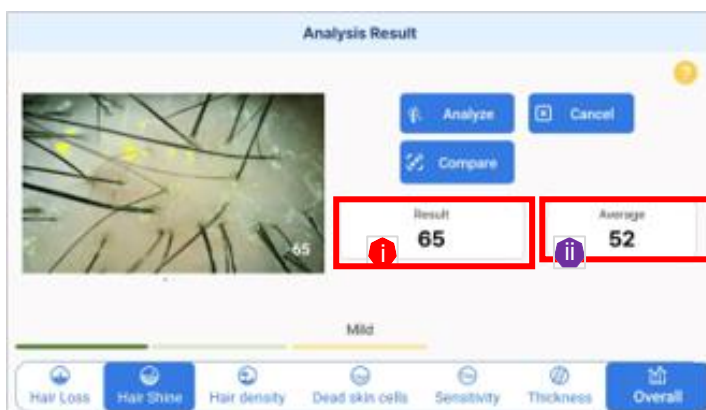

- i** Results indicate individual image score
- ii** The Average Score may differ from Results as it represents the overall captured images under a specific hair parameter.

RESULTS

- HAIR DENSITY RESULTS

The following CHOWIS hair density grade has been co-developed by CHOWIS and dermatology experts. To obtain the hair density grade, first our advanced AI detects hair follicles and the number of hairs in each follicle. Then the average number of hairs per square centimetre is calculated as the hair density Result score for the image. We compute the final score for hair density as the Average of all result scores. Finally we grade hair density as clear, almost clear, mild, moderate and severe.

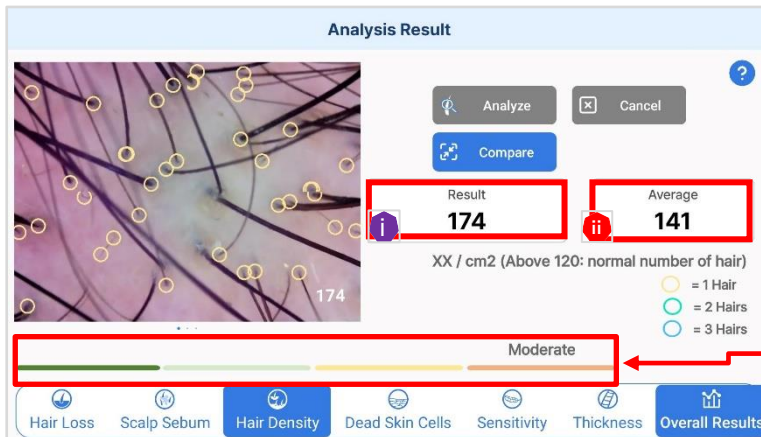

i Results indicate individual image score

ii The Average Score may differ from Results as it represents the overall captured images under a specific hair parameter

Result score levels

Compare function is required to make consultation easier, as it shows how different condition stages look like, while comparing it with captured image, client can easier understand how good or bad their scalp conditions is

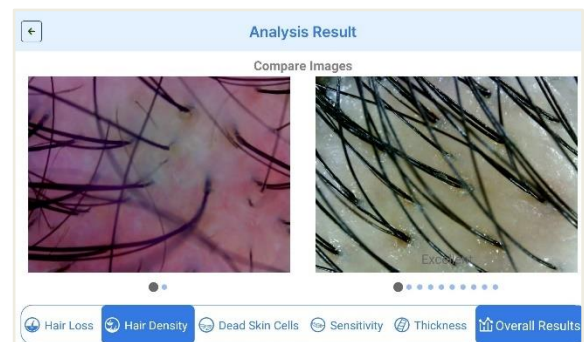

Grade for Hair Density	Scale	Description
Clear	227+	The person has hair thicker than average
Almost Clear	181 ~ 227	Good hair density: no need to be concerned about hair loss
Mild	152 ~ 180	Normal hair density
Moderate	106 ~ 151	Low hair density: starting to notice hair thinning
Severe	0 ~ 105	Very low hair density: suffering from severe hair loss

RESULTS

- DEAD SKIN CELLS RESULTS

The Dermobella Hair Algorithm evaluates the amount of keratin present on For each image, we detect and visualize scalp keratin as white color and provide a quantified Result score. The final score for scalp keratin is computed as the Average of all result scores, and the score is assigned from 0 to 99, where the lower the score, the less possibilities of having issues with dead skin cells. We then grade scalp keratin into clear, almost clear, mild, moderate, and severe.

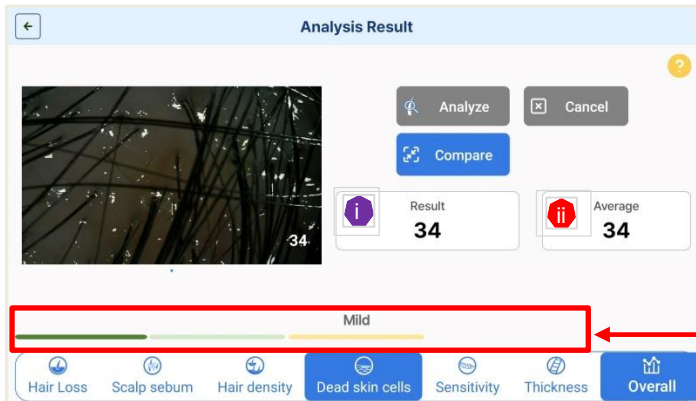

- i Results indicate individual image score
- ii The Average Score may differ from Results as it represents the overall captured images under a specific hair parameter

Compare function is required to make consultation easier, as it shows how different condition stages look like, while comparing it with captured image, client can easier understand how good or bad their scalp conditions is

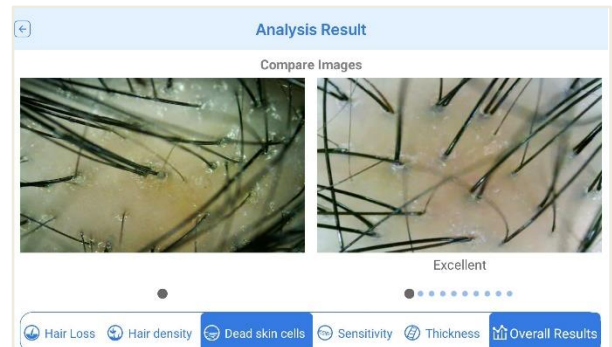
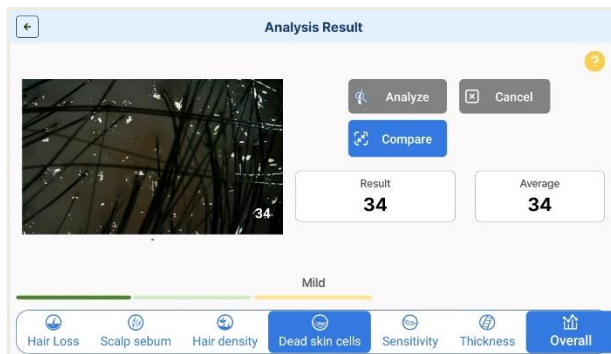

RESULTS

- SENSITIVITY RESULTS

For each image, we detect and visualize scalp sensitivity as light red color and provide a quantified Result score. The final score for scalp keratin is computed as the Average of all result scores, and the score is assigned from 0 to 99, where the lower the score, the closer the result to Normal scalp. We then grade scalp sensitivity into clear, almost clear, mild, moderate, and severe.

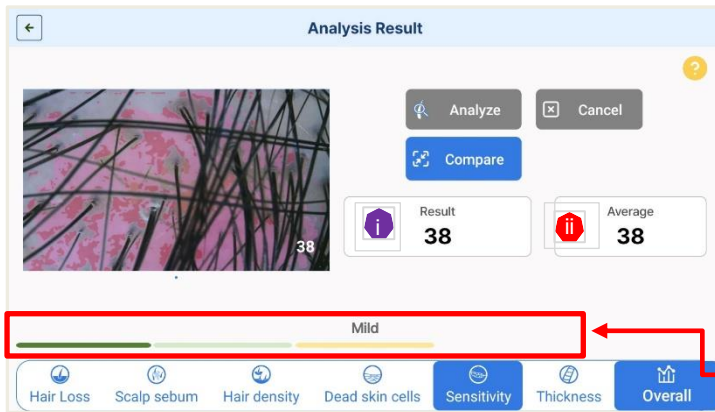

i Results indicate individual image score

ii The Average Score may differ from Results as it represents the overall captured images under a specific hair parameter

Result score levels

Compare function is required to make consultation easier, as it shows how different condition stages look like, while comparing it with captured image, client can easier understand how good or bad their scalp conditions is

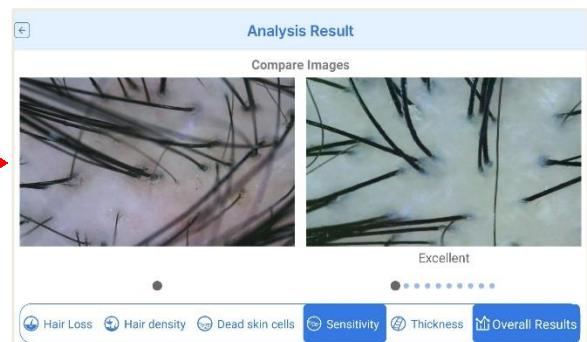
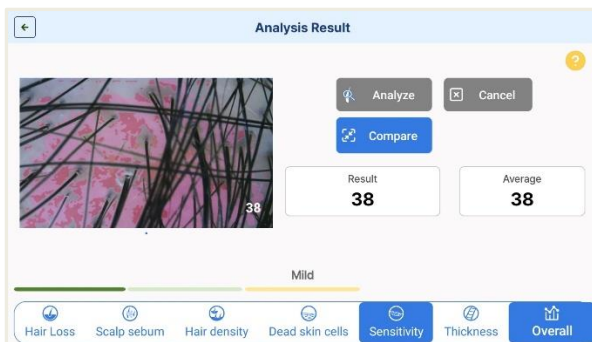

RESULTS

HAIR THICKNESS RESULTS

The Dermobella Hair Algorithm analyzes the hair in the captured image by measuring its thickness in millimeters. And then the Average hair thickness will be obtained in level of 1, 2, or 3 following the 3-point scale shown in Table below. With the scale, the final result will be graded for hair thickness as Fine, medium, or Coarse.

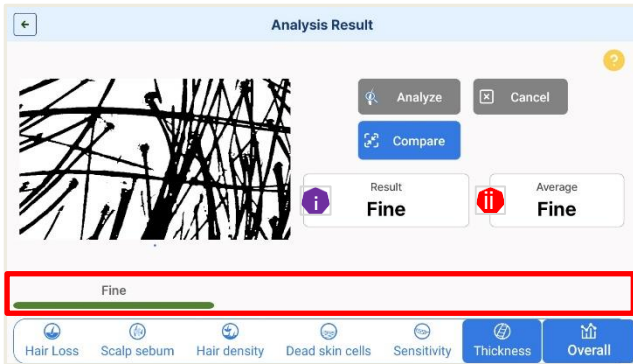

i Results indicate individual image grade

ii The Average may differ from Results as it represents the overall grade of the Hair Thickness

Hair Thickness Grade

Grade	Scales of CHOWIS Hair Thickness	Traits
Fine	1 (0.017 ~ 0.050mm)	Vulnerable to damage and breaks easily. Can get oily easily. Hard to keep a hair style.
Medium	2 (0.051 ~ 0.075mm)	Easier to keep hair style. More resistant to breaking.
Coarse	3 (0.075mm ~)	Can hold a hair style very well. More tolerant to heat, hair dye and styling products. Resilient to breakage. Can get frizzy in humid weather due to higher porosity.

Compare function is required to make consultation easier, as it shows how different condition stages look like, while comparing it with captured image, client can easier understand how good or bad their scalp conditions is

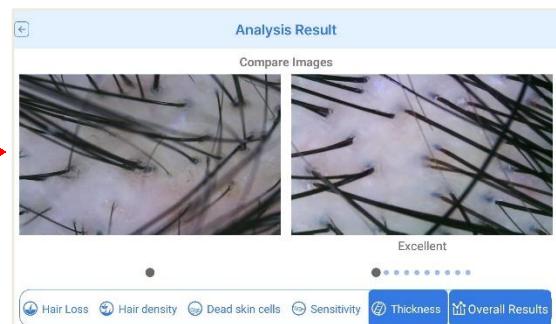

CUSTOMER MANAGEMENT

OVERALL RESULTS

Tap **'RESULTS'** after the analysis is completed, all the analyzed results are shown in numbers, bars, and diagrams

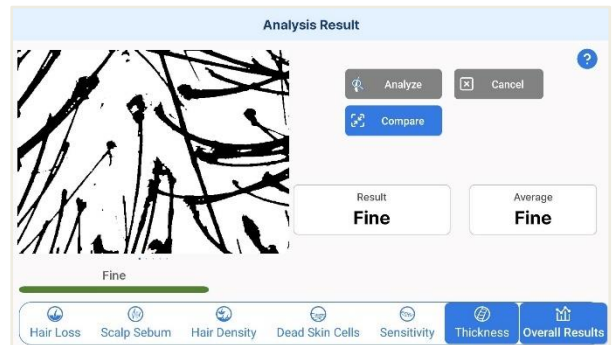

- Results Page

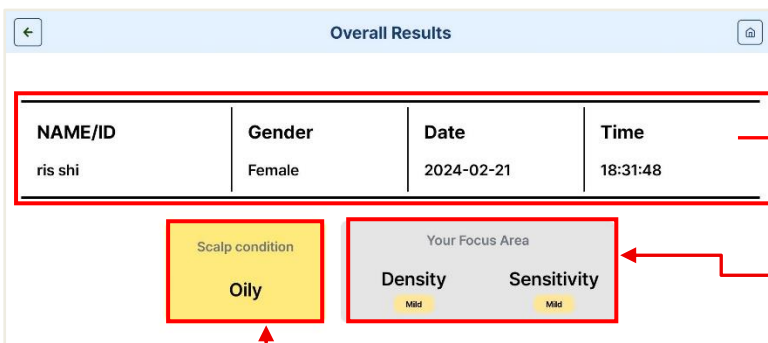

Customer & analysis time information

Focus area to take care of

Scalp Condition

SPIDER GRAPH

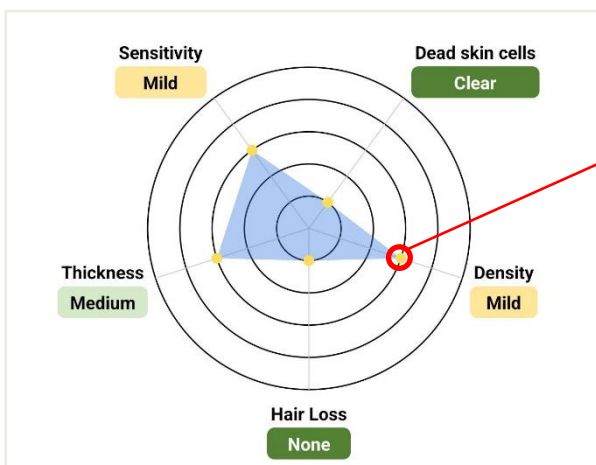

VERTEX (end point)

When the vertex for a specific measurement is positioned closer to the center of the graph, it signifies a favorable hair or scalp condition. This suggests that the hair measurement is well within a healthy range. If the vertex is stretched away from the center, it indicates that more attention to care is required.

CUSTOMER MANAGEMENT

BAR GRAPHS

The results for all measurements will be represented as a bar graph.

This bar graphs will have average scores and the grade assigned for each measurement.

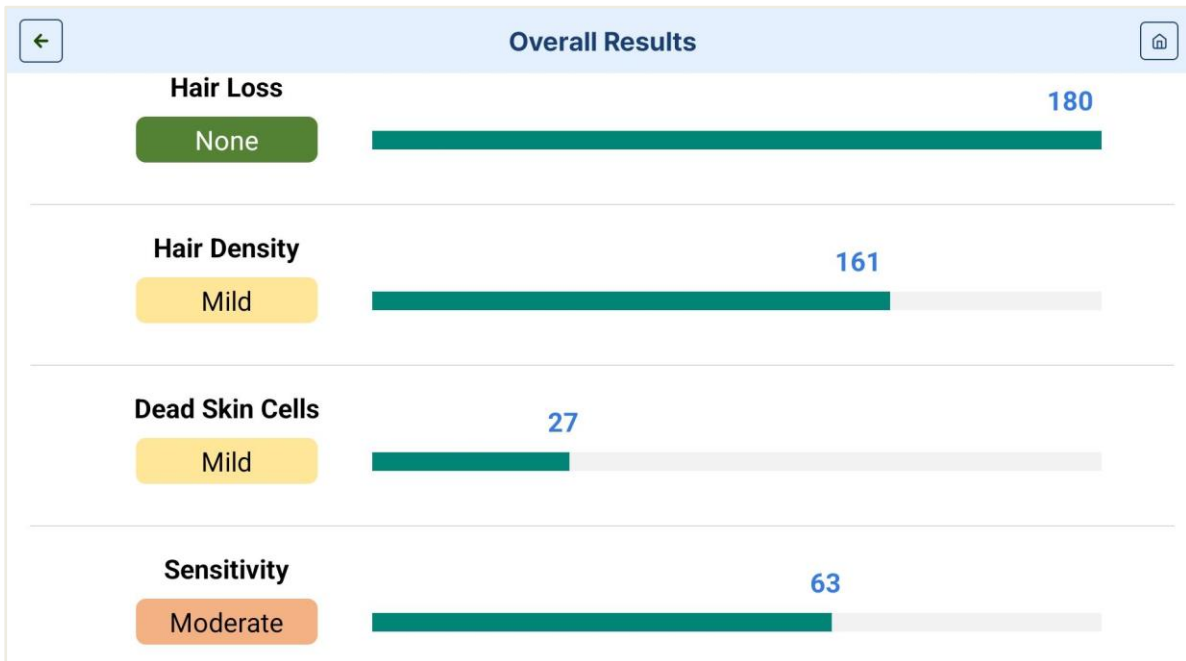

COMMENTS SECTION

To leave a comment on the results page for customer management or future reference, press **'Comment'** from the Diagnosis Result screen and type the necessary comment (max char = 499), and then **'Save'**.

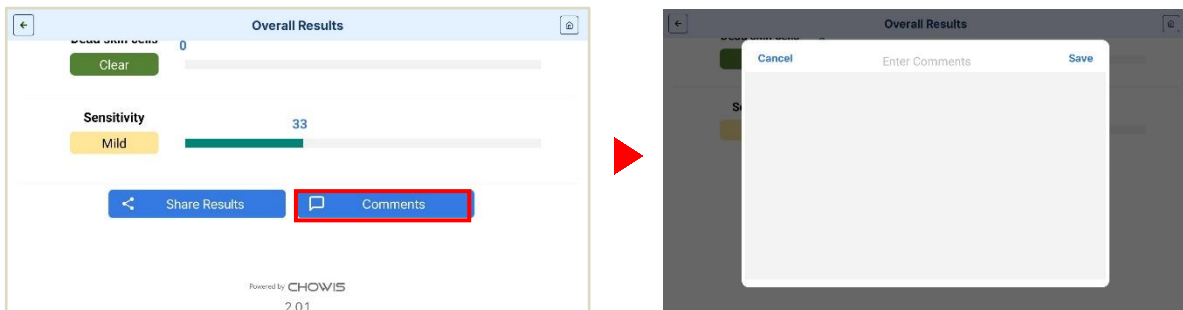

Note: Comments function is only for temporary saving, after logout comments will be deleted.

CUSTOMER MANAGEMENT

SHARE RESULTS

1. Tap '**SHARE RESULTS**' at the bottom of the result screen to share the results then, type the recipient's email address
2. Once done, press on the "**Save**" button to share results through email.

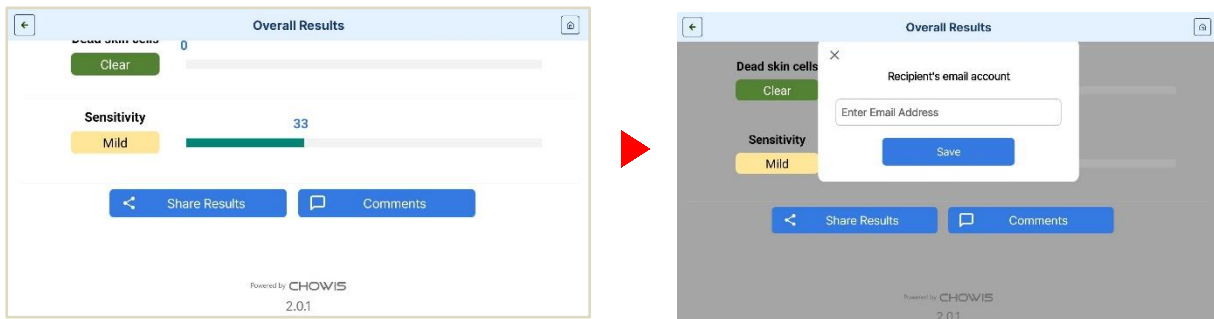

UPLOADING OF DATA TO CLOUD

Upon successful result sharing, the data will be automatically saved to the cloud.

NOTE: To successfully upload data to the cloud and to share the result via email, you must be connected to the internet

CUSTOMER MANAGEMENT

MANAGE CUSTOMER

Tap **"TOTAL ANALYSIS"** from the main screen and type the name, email address, or mobile no. of the customer on the search bar. The corresponding result will be listed.

1. Select the customer you want to check and tap the **HISTORY** button to see all the records such as personal information, diagnostic history, images, and more.

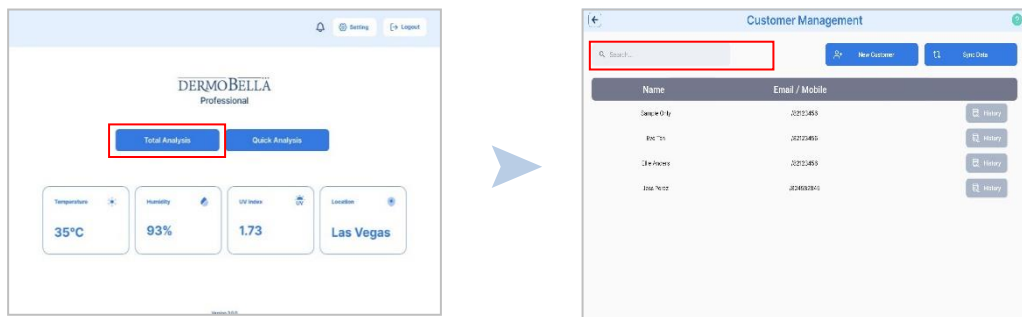

2. Just do a long press to the customer's name to choose from the option- Analyze, Edit Customer (to modify information), and Delete Customer (to remove the customer from the list)

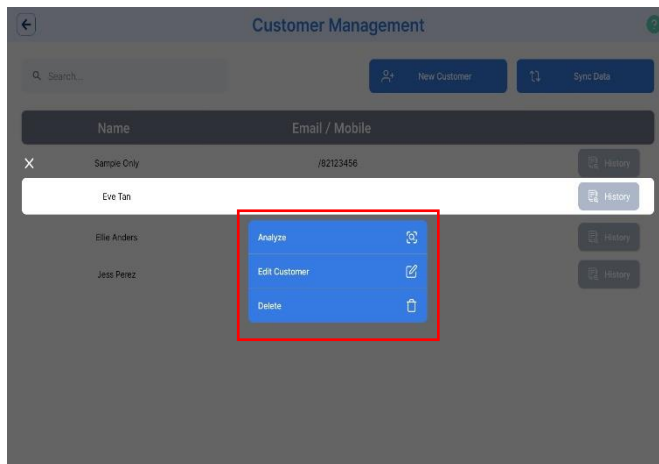

NOTE: It requires an internet connection for saving edited customer information or delete the customer

VIEW RECORDS

COMPARE ANALYSIS RECORDS

1. Press **"History"** button to view all the saved diagnosis results according to dates.
2. From the list of diagnosis results, check the data you would like to compare and press **'COMPARE'**. The data comparison will be shown in the line diagram below.

The screenshot shows the 'Customer Management' interface. On the left, a table lists customers with their names and email addresses. A red box highlights the 'History' button next to 'Franz Locsin'. An arrow points to the right, showing the 'History' interface for Franz Cyril Locsin. This interface displays a table of diagnosis records with columns for Date, Hair Loss, Hair Density, Dead Skin Cells, Sensitivity, Thickness, and Status. Two records are selected with checkboxes. A red box highlights the 'Compare' button at the bottom right.

Date	Hair Loss	Hair Density	Dead Skin Cells	Sensitivity	Thickness	Status
20-00-20	21	21	21	21	21	🔴
20-00-20	12	12	12	12	12	🔴
20-00-20	12	12	12	12	12	🟢
20-00-20	01	01	01	01	01	🟢

3. To view the Graphical history of just one specific measurement, press on the button options below:



VIEW RECORDS

VIEW IMAGES

1. Choose the analysis result that you would like to view the images, and tap the **"VIEW IMAGES"** from the diagnosis record.

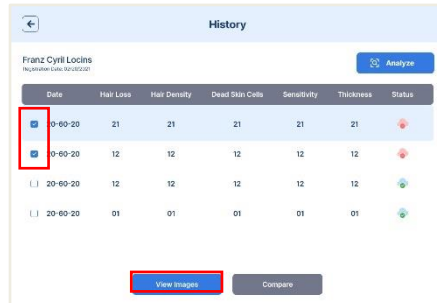

2. Choose 2, 4, or 6 images to compare and selected images will be compared as below (depends on 2, 4, or 6 selections). Tap **"Preview"** to view the image on a larger scale.



3. If you wish to delete an image, select an image then tap **"Delete"** to proceed.

VIEW RECORDS

PREVIOUS ANALYSIS RESULTS

1. From the Dashboard, click the Total Analysis. Select the name of the customer, then tap the **"History"** button.

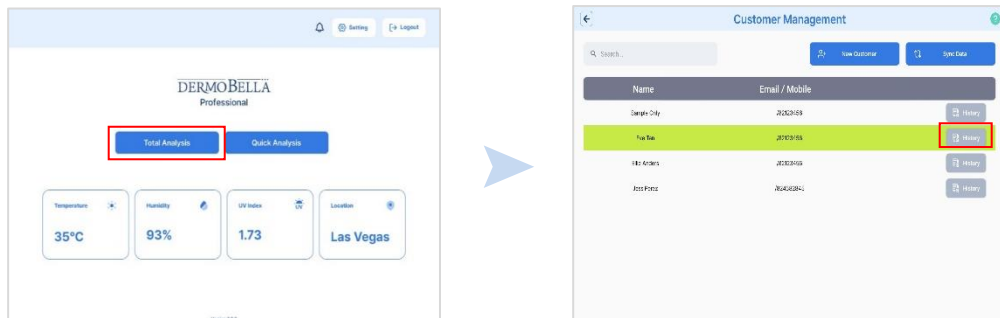

2. After tapping the History button, you will proceed to the Customer's Management History where the dates and scores of the analysis is displayed. Select and long press the desired analysis record. Click the **"View Results"** button.

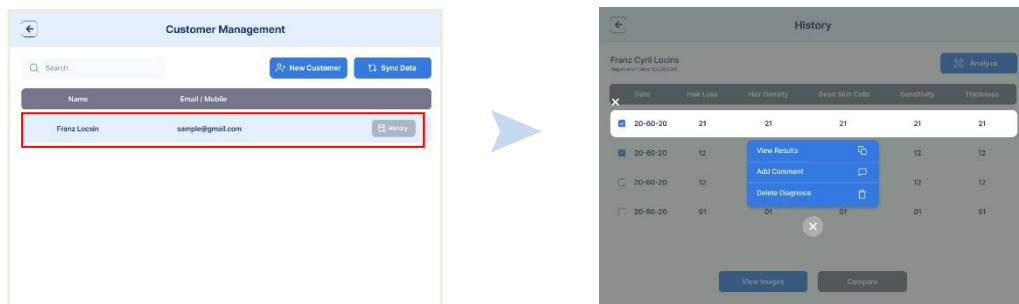

3. Results screen will be displayed to view previous analysis results.

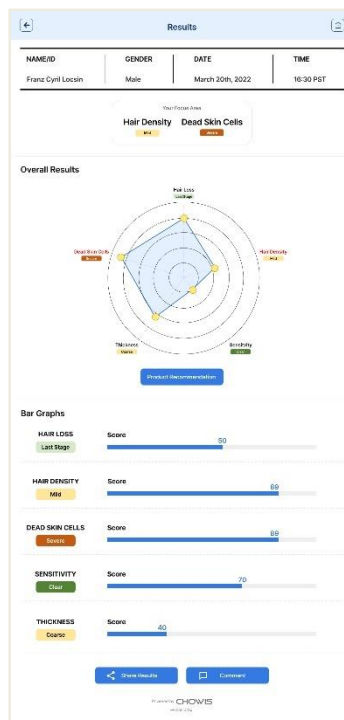

SETTINGS PAGE

GENERAL SETTINGS

You can customize the background, enable/disable options and set up security.

- GENERAL OPTIONS

1. Sleep Mode Timer – This will let you change the skin analyzer idle or sleep mode time.
2. Questionnaire – If this option is enabled, the questionnaires will be displayed after pressing on the Analyze button. If disabled, captured images will be analyzed and it will automatically present the overall results.
3. Environmental Dashboard – Temperature, Humidity, UV index, and Location will be displayed on the screen if enabled. These 4 will be hidden when selecting Disable.
4. Analysis Mode: Online and offline analysis options are available as needed. For offline analysis, please ensure that the data is uploaded by the end of the day.
5. Scalp Condition - By default, the scalp sebum option is enabled. To select Hair Shine Algo instead, choose it from the dropdown menu and click save.

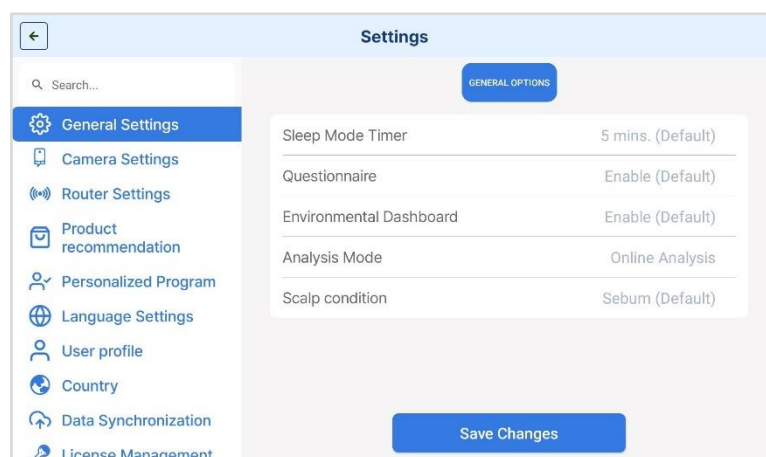

SETTINGS PAGE

GENERAL SETTINGS

6. Skin Group Selection – In General Settings, you can choose how to select the skin group. The default setting (Auto + Manual) automatically captures from the scalp and lets you adjust it, while Auto captures from the cheek, and Manual uses a color chart.
- Auto + Manual Group Selection: Before capturing, select the LED light mode for the appropriate skin group. Then, place the lens on the frontal scalp, capture the image, and the skin group will be automatically assigned.

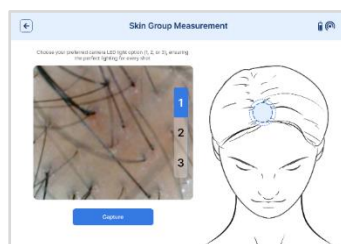

- Auto Group Selection: In Auto Mode, the app automatically detects the skin group when you capture an image from the cheek. Click Proceed, and you can edit the skin group later in CRM if needed.



- Manual Group Selection: When adding a new customer, manually enter the Skin Group by selecting it from the color chart. You can update the Skin Group later in CRM if needed.

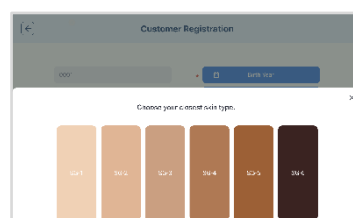

SETTINGS PAGE

CAMERA SETTINGS

The camera setting is where you can set up the Optic Number of your device.

1. Go to **Settings > Camera Settings** to add or remove device.

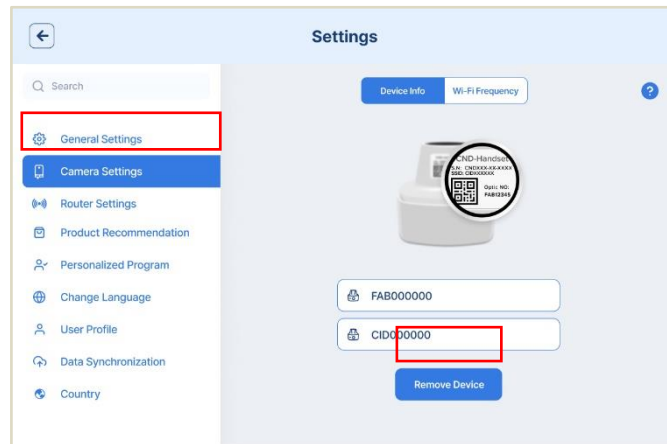

2. Scan the QR code on the device or paper to automatically register or enter manually input the optic number of your device.



OR



NOTE: This operation requires an internet connection to proceed.

SETTINGS PAGE

CAMERA SETTINGS

- WI-FI FREQUENCY

Wi-Fi Frequency can be set to 5.0 GHz for faster connection of the device.

1. Device must be set up and should be connected to the app prior to switching to 5.0 GHZ.
2. Once switch is successful, the SSID (Wi-fi signal of analyzer) from the WI-FI settings should have a 5G at the end of it. (ex: CID000011-5G)

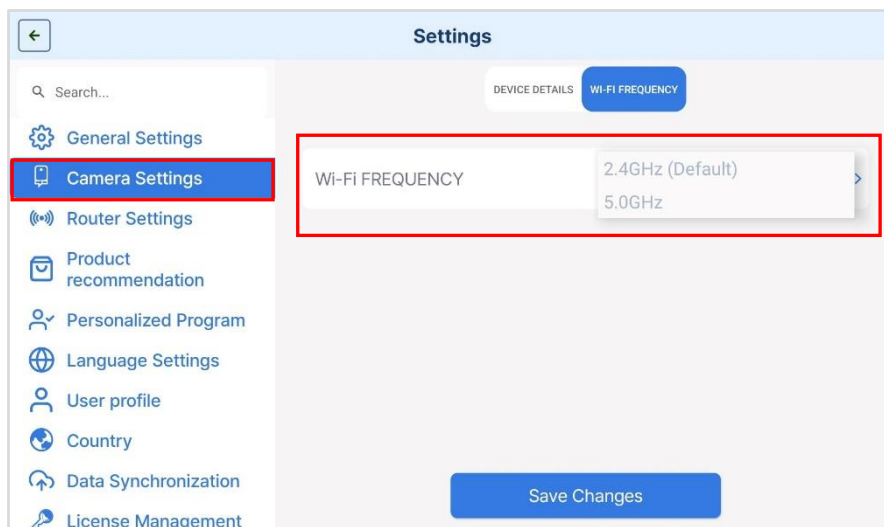

SETTINGS PAGE

ROUTER SETTINGS

- ROUTER SETTING

Go to Settings >Router Settings. Click on 'Connect'.

1. Select your internet's Wi-Fi router and click on it.
2. Enter your Wi-Fi router password. Then, click on 'Proceed'.
3. Window pops up to connect to device; click on 'Connect'.
4. The Wi-Fi router **set-up is completed**.

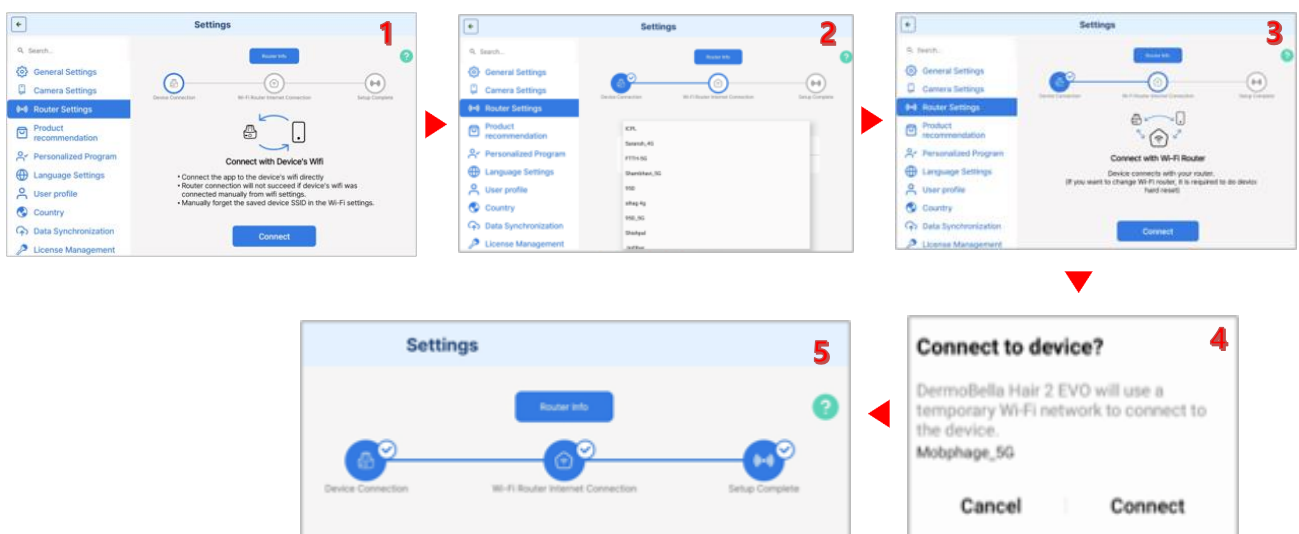

SETTINGS PAGE

ROUTER SETTINGS

- ROUTER SETTING (RESET TO DIRECT MODE)

1. Go to 'Router Settings'.
2. Click on 'Reset'.
3. While switching back connection, reset the device by pressing the capture button for 10 secs until red light comes.
4. Window pops-up stating Reset SSID successful.
5. The Router Settings will be reset.



SETTINGS PAGE

PRODUCT RECOMMENDATION

You can set up products you would like to recommend based on the diagnosis result.

1. Go to **Settings > Product Recommendation**. Tap the **+** icon to **"Add Product"**. Tap **Product Mode**, then, scroll up and down to select.

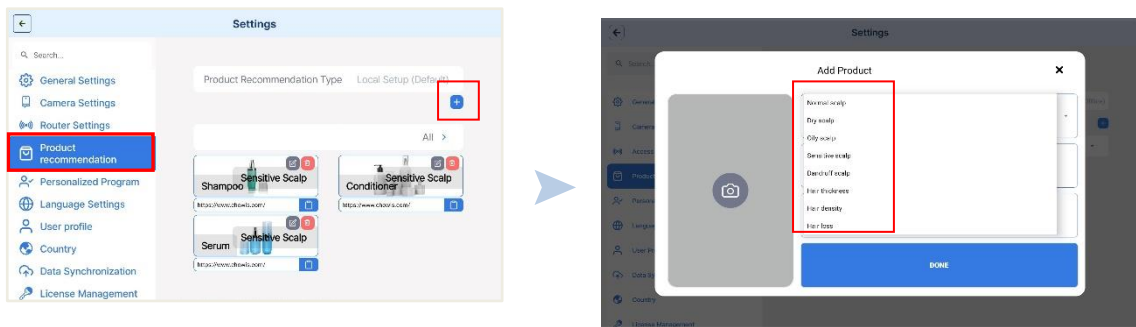

2. After selecting a Product Mode, press on the CAMERA icon to upload a product image from the device's local storage (ALBUM/GALLERY). Choose the desired product image to proceed.

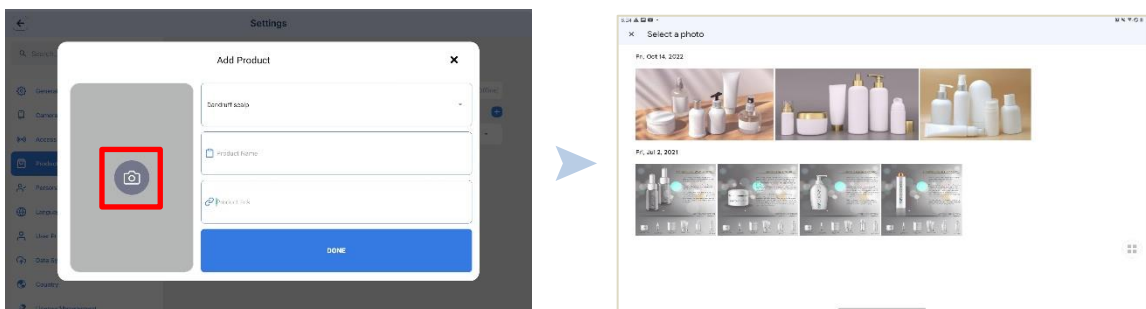

3. Ensure that there is a **"Product Mode"** selected then type in the **"Product Name"**
4. Input **"Product Link"** (optional), and press **DONE**
5. Uploaded product will appear by pressing measurement name on piechart, on the result page

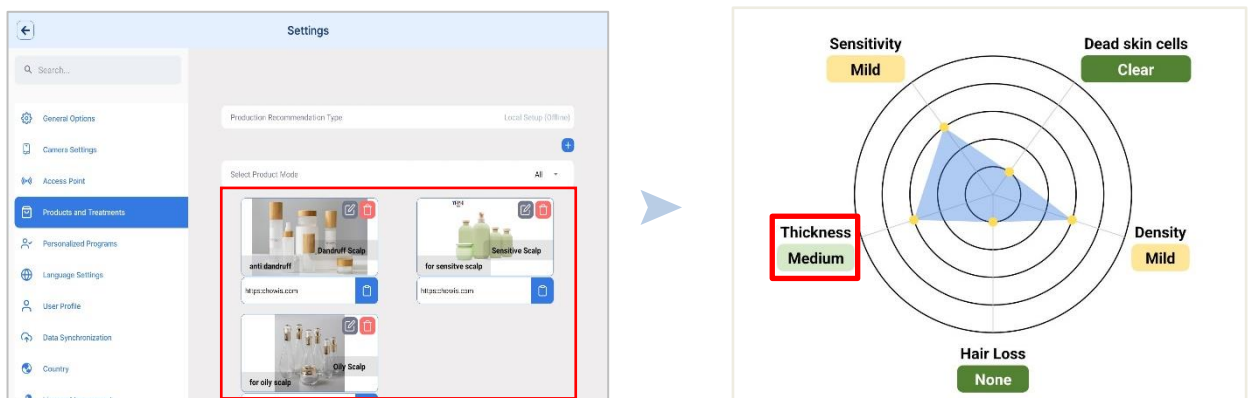

SETTINGS PAGE

PERSONALIZED PROGRAM

Personalized programs is an analysis mode where you can have your customized diagnosis program by selecting any measurement you want to have.

1. Go to the **"Settings"**. Select the **"Personalized Program"** on the right screen. Tap the Program bar to view the list of programs created.

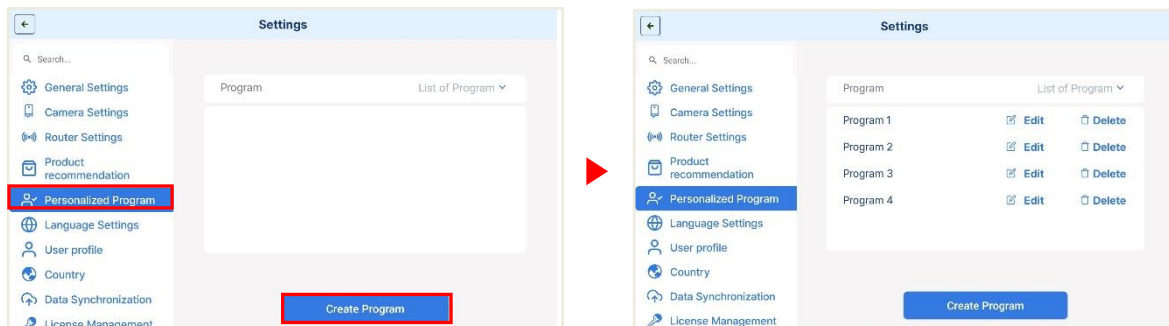

2. Tap the **"Create Program"** button, enter the name of your program and select the measurements you want to include then **'Create Program'**.

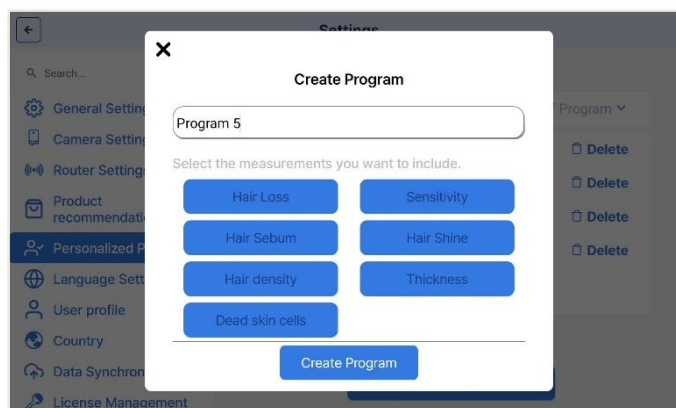

SETTINGS PAGE

LANGUAGE SETTINGS

You can choose and change the language of the application.

1. Go to **Settings > Change Language**. Tap the Language bar and scroll up and down to select the Language you prefer. Then, press **"Save"**.

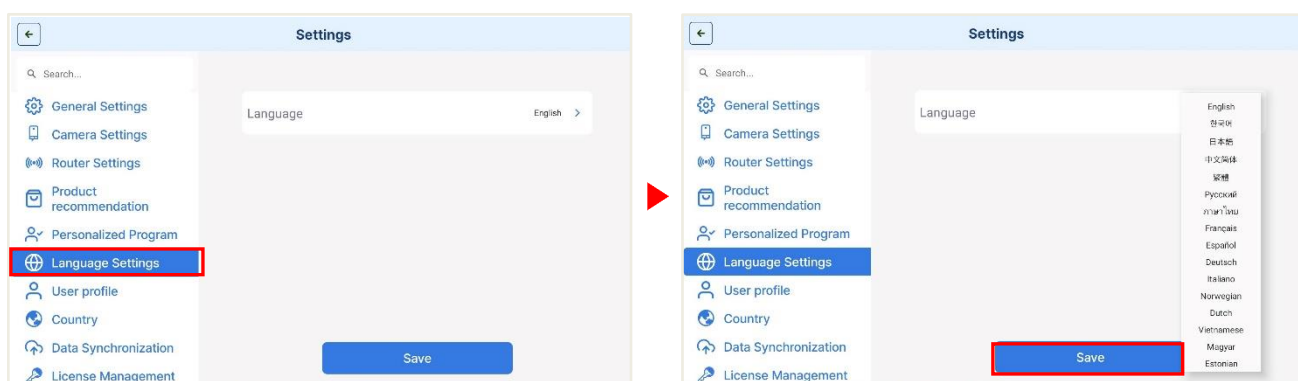

SETTINGS PAGE

USER PROFILE

You can find and update the User Information, Device Details, and Change Password.

CHANGE PASSWORD

1. Go to **Settings > User Profile**. Tap the **"Change Password"** button.

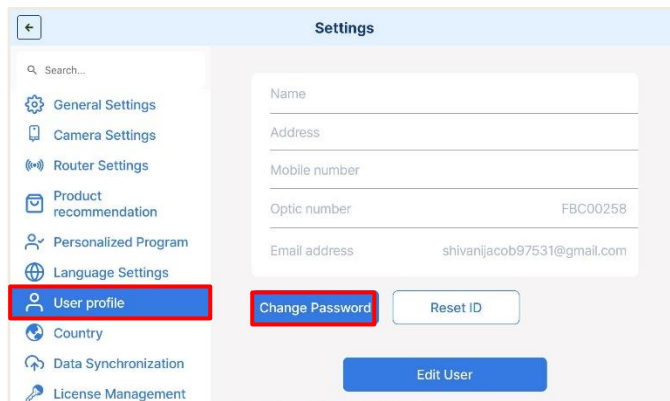

2. Enter your Old Password and New Password and press save. After successful password change, please, login again with your new password.

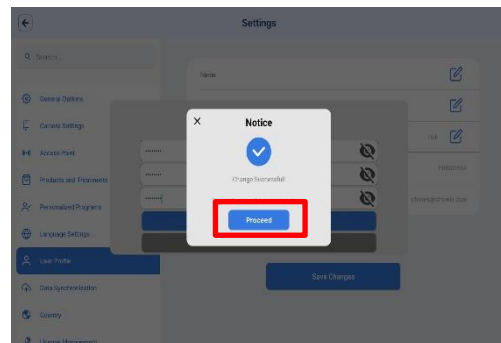
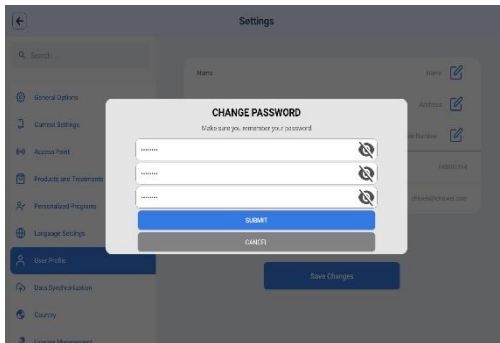

SETTINGS PAGE

RESET ID (Changing email that is used for login)

1. Go to **Settings > User Profile**. Tap the **"Reset ID"** button.

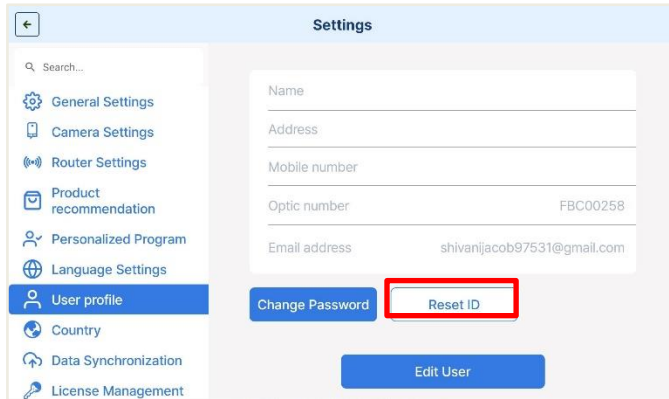

2. To proceed with Email Reset, fill out the necessary information as shown on the image below. Once done, press on **Proceed**
3. Review all the information on the screen, especially the new email address. Once ready, press on **CONFIRM** button to complete USER ID Reset

NOTE: This operation requires an internet connection to proceed.

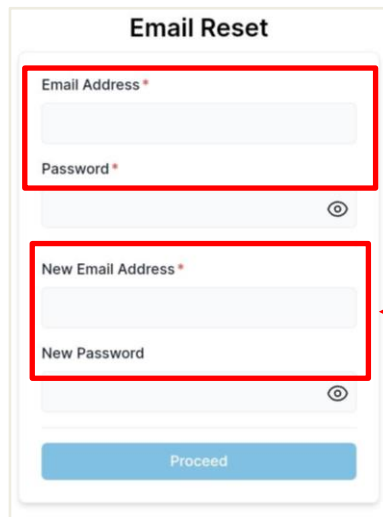
A screenshot of the 'Email Reset' form. It has two main sections. The first section contains 'Email Address *' and 'Password *' fields, both highlighted with a red box. The second section contains 'New Email Address *' and 'New Password' fields, also highlighted with a red box. A blue 'Proceed' button is at the bottom.

Input the existing log in email and password

Input the new email that you wish to register and create a new password and click on **Proceed**.

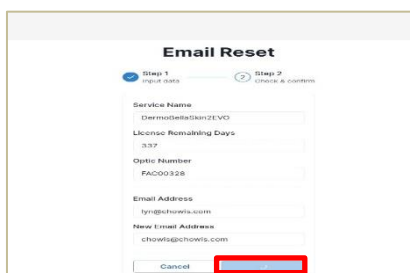
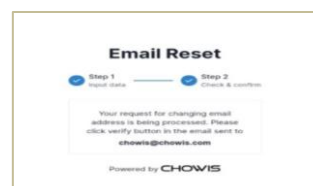
A screenshot of the 'Email Reset' form in 'Step 1: Input data'. It shows a summary of the user's information: Service Name (Diermodetech/DELVD), License Remaining Days (337), Optic Number (FAC00328), Email Address (ty@deltech.com), and New Email Address (chowis@chowis.com). A red box highlights the 'New Email Address' field. There are 'Cancel' and 'Proceed' buttons at the bottom.A screenshot of the 'Email Reset' form in 'Step 2: Check & confirm'. It shows a confirmation message: 'Your request for changing email address is being processed. Please click verify button in the email sent to chowis@chowis.com'. Below the message is a 'Verify' button. The screen is powered by CHOWIS.

SETTINGS PAGE

DATA SYNCHRONIZATION

Allows to upload and save data or analysis on your device and cloud with regular update.

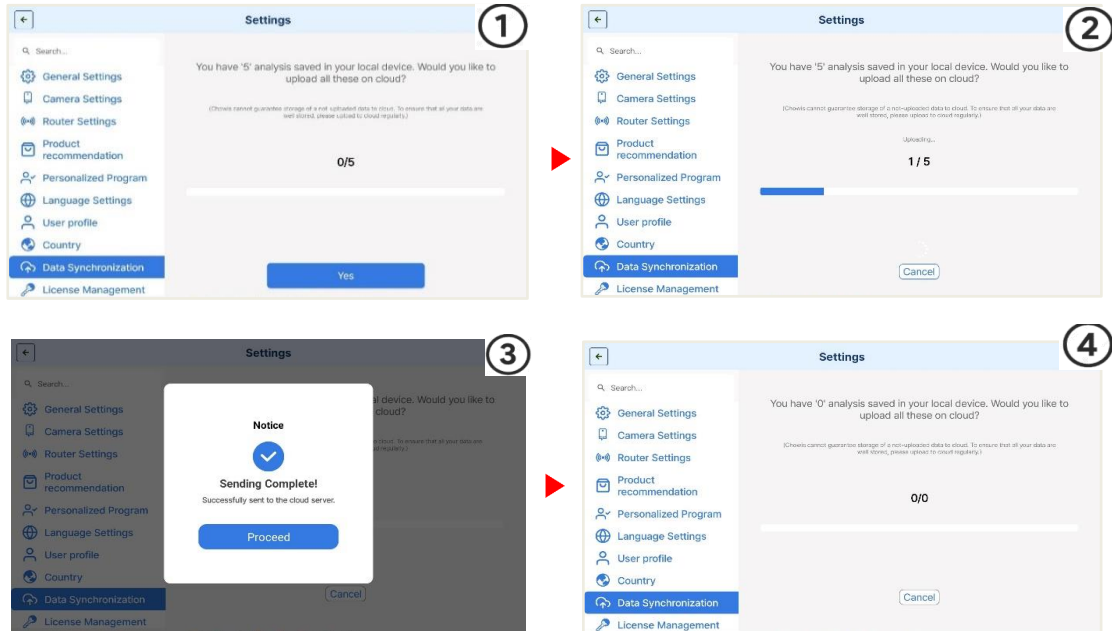

DATA SYNCHRONIZATION VIA CRM ONE BY ONE

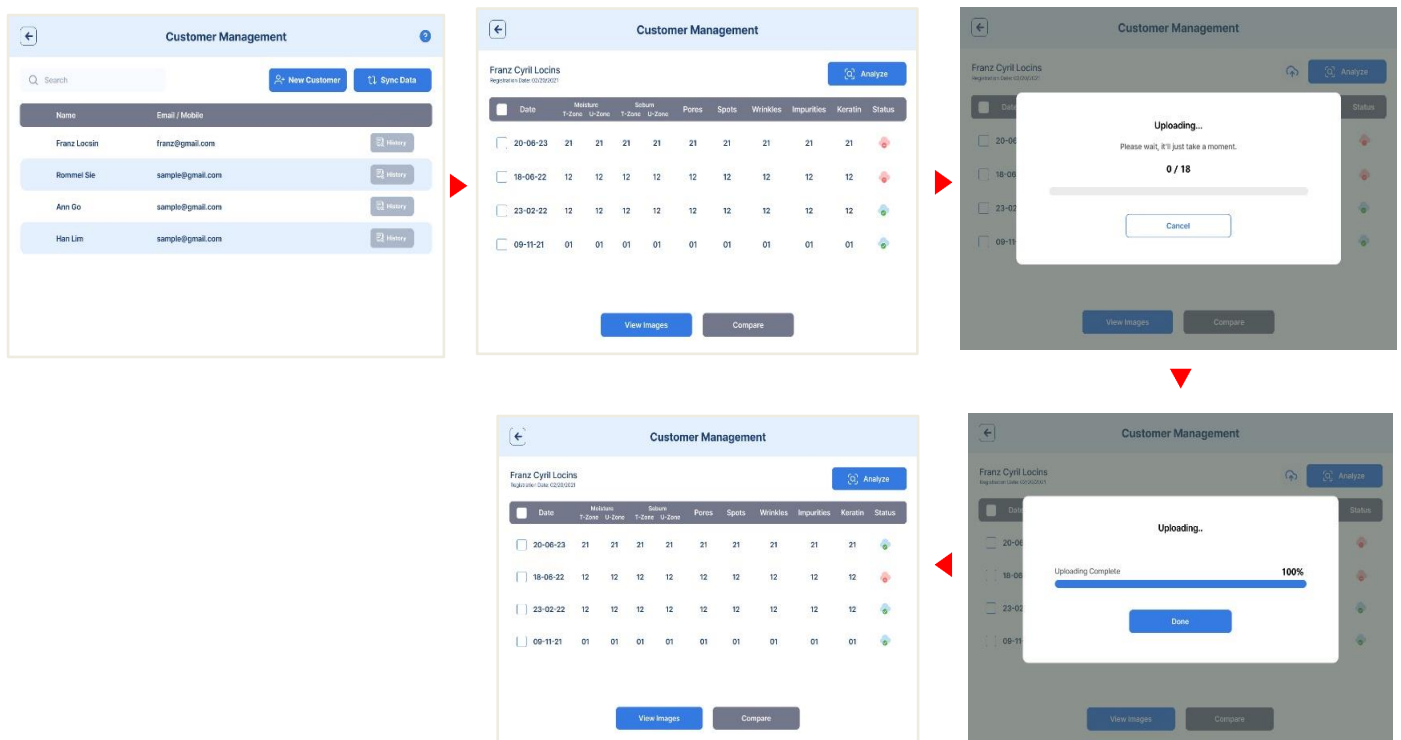

SETTINGS PAGE

LICENSE MANAGEMENT

You can access information regarding the Activation and Expiration date of your License. This section also displays the remaining days of your active license.

Extend License – Consultant can purchase additional days to the current license in use. If your license is expired, a message will pop up when you log in, asking you to renew it.

Select the duration for the extended license in the next window and confirm.

Change License Type – Consultant can upgrade the current license to a higher one.

If original license is Expert; then display only Pro .

If the original license is Pro; then display only Expert

NOTE: If you bought your device from an agent, you can't handle the payment. Please reach out to the agent you purchased the device from if you need to renew the license.

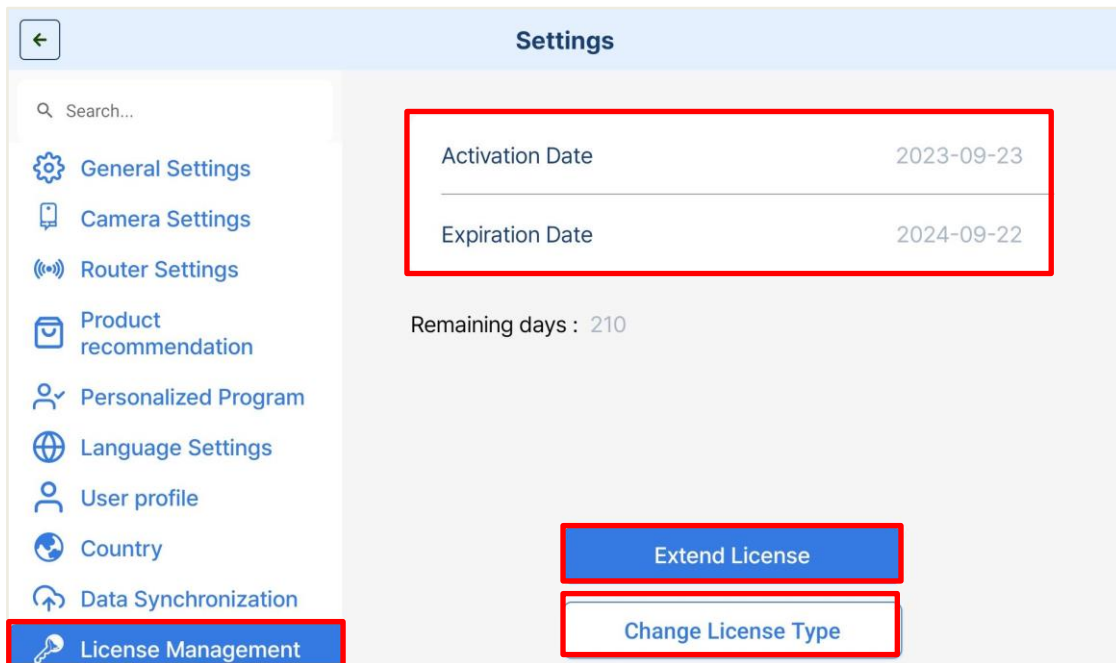

DIAGNOSIS SYSTEM IN USE

USER AND CUSTOMER REGISTRATION

Chowis' diagnostic system is linked to a unique user ID (email) and only the corresponding ID can be used. If you wish to change your ID, please, do so within the program under settings page.

When create a new account, an email will be sent from CHOWIS-SERVICE. Open email and click on the "VERIFY" button. If you have difficulty in getting email, please check your junk/spam mailbox. Without email confirmation, login is not possible.

Each user has the authority to manage their own customer list. However, this accessibility is possible only when the customer list is being synchronized and uploaded to the server. As a precautionary measure, it is advisable to perform a daily backup to ensure data security.

When creating a new account, logging in, and inputting optic number, ensure that your tablet or mobile phone is connected to the internet and not to the diagnostic device.

ACCURACY OF ANALYSIS AND COMPARISON OF BEFORE AND AFTER

Chowis' analysis system analyzes local areas. Therefore, when comparing before and after diagnosis results, accurate results can only be compared when the same position is taken.

CHARGING RELATED SCENARIO

Charge the device while it is off for fast charging. When you connect the charging cable to a device that is on, the indicator light will be red. However, if the device is off, the red indicator will not light up even during the charging process.

We recommend using the provided Chowis cable for charging whenever possible. If you use a different cable, it may not perform proper charging.

DIAGNOSIS SYSTEM DOES NOT TURN ON.

If the handset is out of battery, the handset does not turn on. Please charge the handset for 2 hours. For charging method, please refer to the Charge the handset on simple manual.

WHILE TAKING IMAGES, THE SCREEN IMAGE IS SLOW OR STOPS

This situation can occur with the interference by environment surrounding the Wi-Fi. In this case change the Wi-Fi channel of the handset. For setting method, please refer to the Change Wi-Fi Channel. Also, verify if you have enough battery left. If the battery indicator is red light, then, we recommend charging first and then use it.

THE HANDSET FEELS HOT.

As the optical unit/lens part emits a lot of LED light and long periods of continuous use can cause the handset to heat up. If the heat is severe, immediately turn the handset off and stop using it until it has cooled down. If the handset is still hot even after a certain period of time has passed, please inquire at a customer support center. Also, a reason for over-heating could be when the handset is left with power switched on during charging. Always remember to turn the handset power off before charging.

SENT E-MAIL WAS NOT RECEIVED.

In order to send email, please check if you have stable internet connection and data synchronization was done, otherwise, it will not send email to customers. In order to synchronize data, please refer to the Data Synchronization settings section.

CONNECTION BETWEEN ANALYZER AND TABLET

WHAT IS AN SSID?

SSID is a unified classification ID for wireless handsets. Because this handset is a wireless system and is connected to a Wi-Fi, for each handset there is a unique SSID. Please verify the SSID on the label attached at the back of the handset.

HOW DO YOU VERIFY THE CONNECTION BETWEEN THE HANDSET AND THE TABLET?

At the Wi-Fi settings screen of the tablet, if the SSID status of the handset is "Connected" and after the start of the program, if the Wi-Fi icon on the top right section of the screen is green, then it is connected normally.

THERE IS NO CHANGE IN CONNECTION STATUS BETWEEN THE HANDSET AND TABLET AFTER "SAVED".

Turn on the switch again and try to connect again manually via Wi-Fi setting of tablet. When connecting to analyzer, use the password "**1234567890**". Even if connection status saying "Connection without internet connection" appears, the actual device connection will not be affected. If you still fail to connect then, press the **CAPTURE** button for 10 seconds until LED starts to blink with red color, so analyzer will start to reset. Please wait until fully reboot and try to connect again.

THERE IS A NETWORK CONNECTION ERROR INDICATION ON THE PROGRAMSCREEN.

If there are many Wi-Fi signals or there are many wireless routers at the handset usage environment, then the connection is delayed and may not be able to connect. Try using it by changing the Wi-Fi channel. For changing the channel method, please refer to the Change Wi-Fi Channel.

APPENDIX

APPENDIX: PROPER IMAGE CAPTURING

1. Place the camera flatly and gently in the middle of the parted hair on the scalp.



Proper Device Placement



Camera lens not placed flatly on the scalp

Improper Device Placement



Device do not have contact on scalp

2. Do not remove the device from the scalp until the captured image or the score shows on the app screen.
3. Give a second or two to make sure that images is well focused before pressing the device's capture button. This would ensure that the image captured is clear and not blurry.

EXAMPLES OF CAPTURED IMAGES

EXAMPLES OF CORRECT AND INCORRECT IMAGES

CORRECT CAPTURED IMAGES

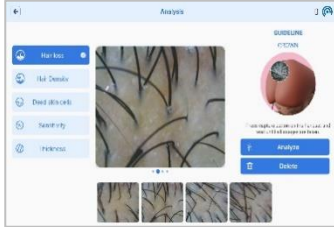

HAIR LOSS

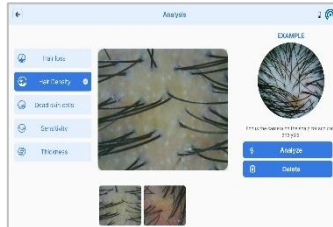

HAIR DENSITY



DEAD SKIN CELLS



SENSITIVITY

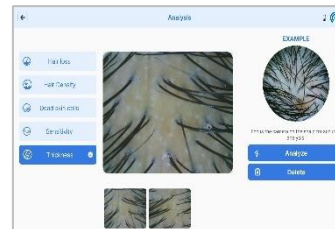

HAIR THICKNESS

INCORRECT CAPTURED IMAGES



Blurry Image



Hair not properly parted

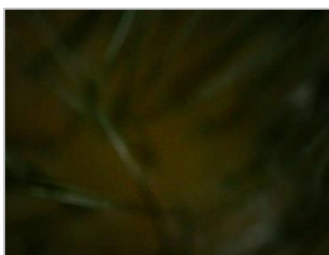

Image too Dark



No clear view of scalp

SPRECIIFICATION

SPECIFICATION

Power supply	Input: 100-240V, 50-60Hz
Support protocol	USB 2.0 Wi-Fi
Measurements (Hair)	Hair loss, Hair Density, Dead Skin Cells, Sensitivity, Hair Thickness
Hair measurements only	20+ LED, Easy shooting and real-time streaming transfer
Measuring method	Use measurement values from 0 to 99 score for each analysis category
Maximum size	Handset: 64 * 65.5 * 58 (mm) Stand: 69 * 65.6 * 72.5 (mm)
Weight	Handset: about 106g Stand: 226g

CONTACT

Email: **chowis@chowis.com**

Skype ID: **chowisofficial**

Chowis Co., Ltd.

Homepage: www.chowis.com

Tel: +82.31.706.7950

Fax: +82.31.272.7950

Address: A-1301-2, 184, Jungbu-daero
Giheung-gu, Yongin- si Gyeonggi-do,
Republic of Korea, [17095]

