

**CHOVVIS**

YOUR CHOICE OF DIAGNOSIS



**dpi** VISO  
USER MANUAL

dermo Pico

For more information visit us at <https://www.chowis.com>.

# CONTENTS

● Device Overview .....	1
● Package Inclusions .....	1
● How to Use .....	2
● Attaching Device to Phone .....	2
● Installing the dpi viso Pico App .....	3
● Connecting Device to Phone .....	4
● Registering New Customer .....	5
● Analyzing Hydration .....	6
● Analyzing Sebum .....	7
● Analyzing Pore, Wrinkle and Impurities .....	9
● Comparing Results .....	11
● Adding product recommendation images .....	12
● Results Sharing function .....	13
● Language Settings .....	13
● Send Images button .....	14
● FAQ .....	14
● Specifications .....	16
● Contacts .....	16

# DEVICE OVERVIEW



- 1. Moisture sensor
- 2. Magnetic attachment
- 3. Micro-USB B port

- 4. Non-removable lens
- 5. Switch On/Off
- 6. Light Indicator

# PACKAGE INCLUSIONS



dpi Viso Device (1)



Charger Adaptor (1)



5-pin UBS Cable (1)



Air Blower (1)



Cleaning Cloth (1)



Magnet (3)

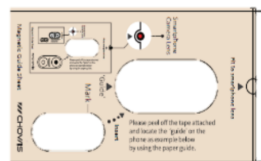

Paper Guideline (1)

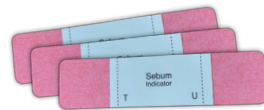

Sebum (50)

# HOW TO USE

## ATTACHING DEVICE TO PHONE

1. Press switch button of the dpiViso device for 3 seconds until LED light blinks.



2. Put paper guide on your phone and attach magnet.

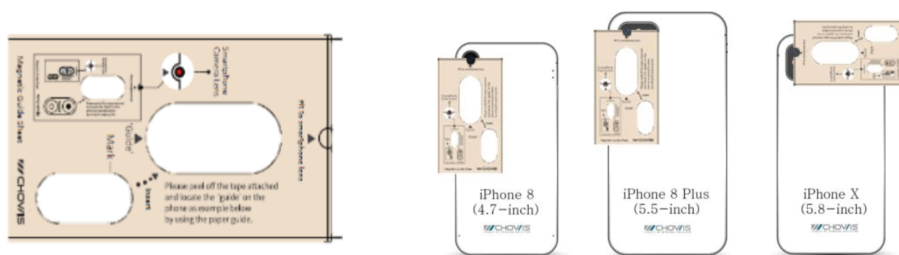

3. Attach the dpiViso device on magnet.



# HOW TO USE

## INSTALLING THE DPIVISO PICO APP

1. Open App Store and type “Chowis.”  
or scan QR code:



2. Select dpiVISO Pico app and install.



# HOW TO USE



## CONNECTING DEVICE TO PHONE

1. Turn on Bluetooth  on your phone.
2. Open dermo PICO app.
3. Choose MAC code of device to connect.

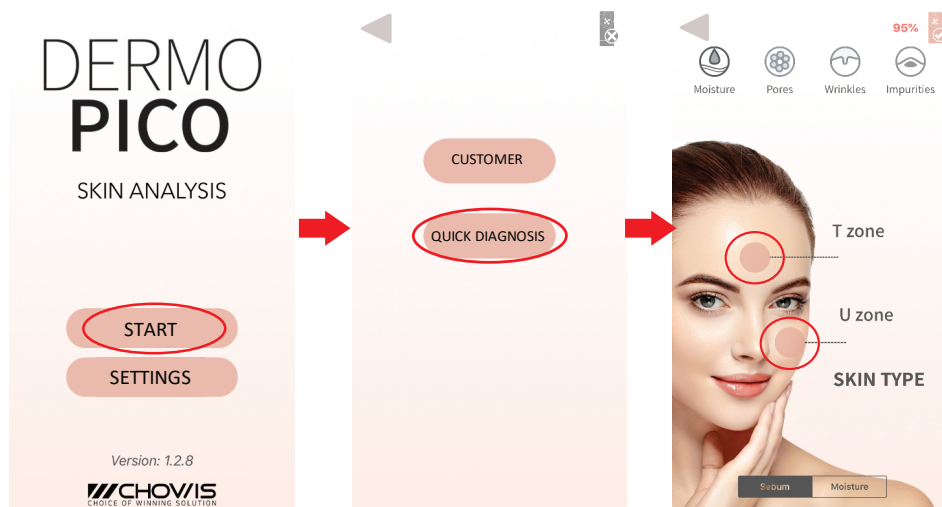

4. After connecting device, press start.
5. Select Quick Diagnosis for quick usage.



 NOTE: If connection was successful, Bluetooth indicator will change to pink  if not it is grey. 

# HOW TO USE

## REGISTERING NEW CUSTOMER

1. Select Customer.

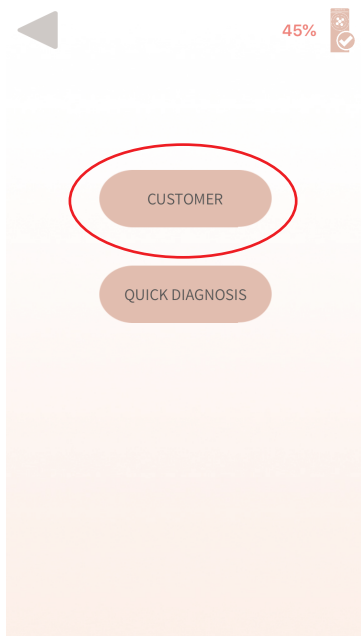

2. Select New Customer.

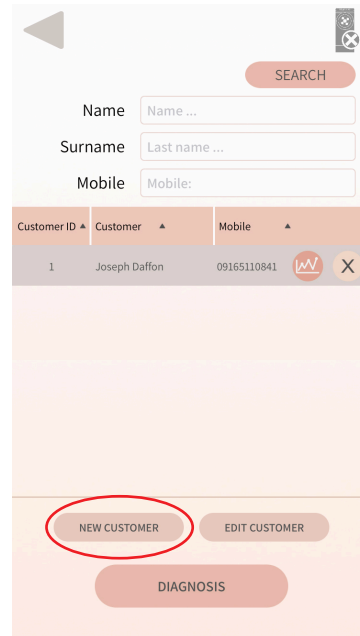

3. Fill up required fields and press Save.

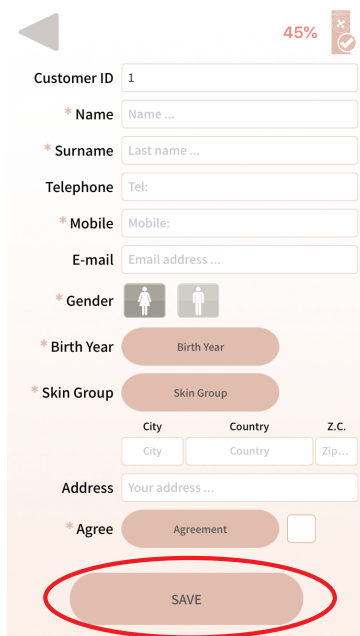

4. Select registered customer and press Diagnosis.

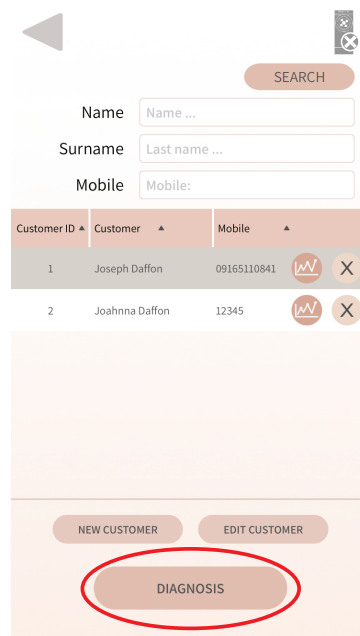

# HOW TO USE

## ANALYZING HYDRATION

1. Select the hydration icon 

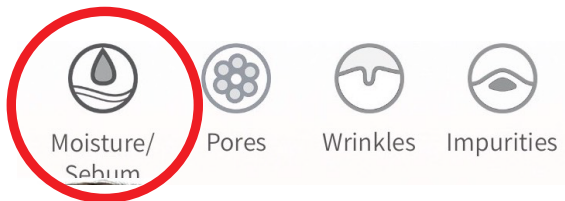

Device's Sensor



2. Place the moisture sensor  on your T-zone.
3. Press button of T-zone in the App.

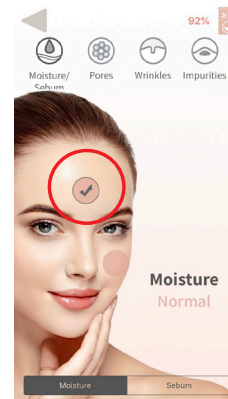

4. Place the moisture sensor  on your U-zone.
5. Press button of U-zone in the App.

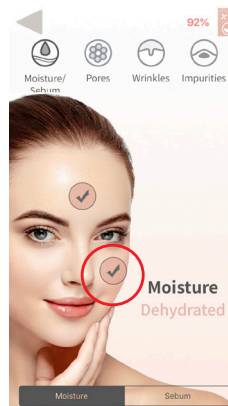



# HOW TO USE

## ANALYZING SEBUM

1. Choose Sebum function on the bottom.
2. Select the T-zone icon on the screen



3. Dab one end of the pink Sebum Indicator on the forehead area for 3 seconds

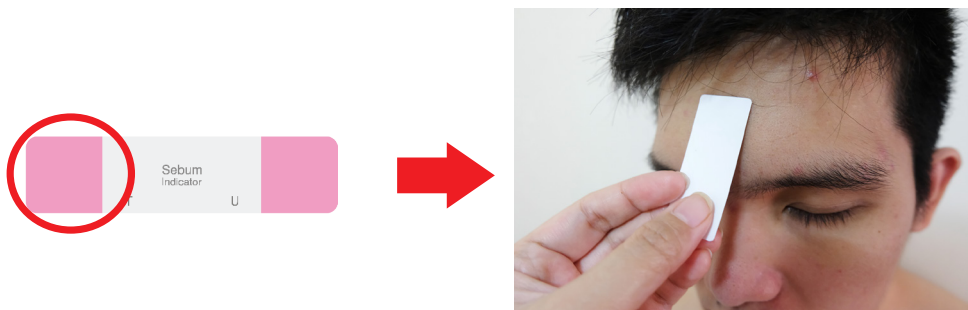

4. Take an image of the Sebum Indicator making sure to include all pink areas on the capture.

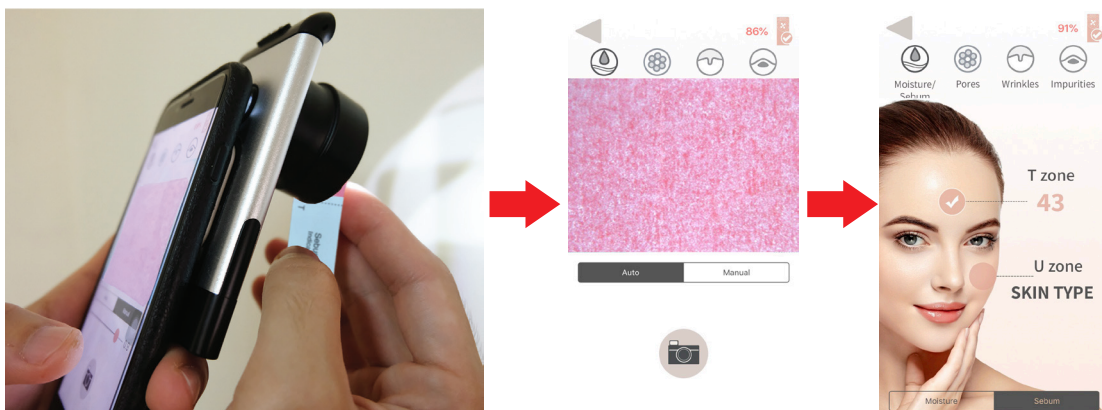

# HOW TO USE

## ANALYZING SEBUM

6. Select the U-zone icon on the screen.



7. Dab the other end of the pink Sebum Indicator on the cheek area for 3 seconds

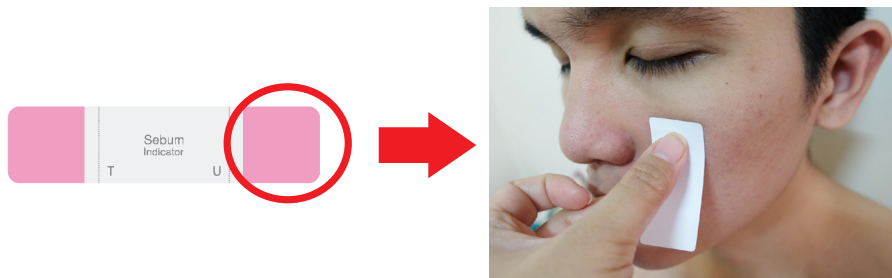

8. Take an image of the Sebum Indicator making sure to include all pink areas on the capture.

7. Scores will be reflected upon successful capture

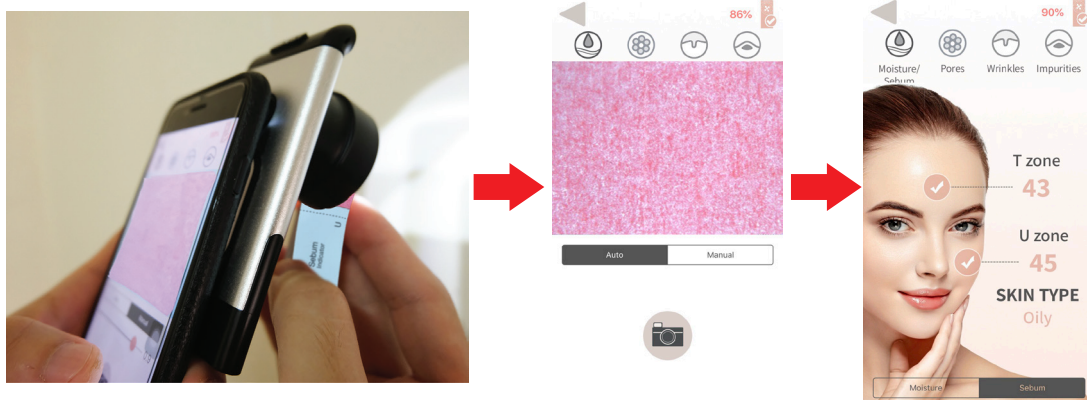

# HOW TO USE

## ANALYZING PORE, WRINKLE, AND IMPURITIES

1. Select the pores icon. 
2. Press the camera button and take a picture of skin.

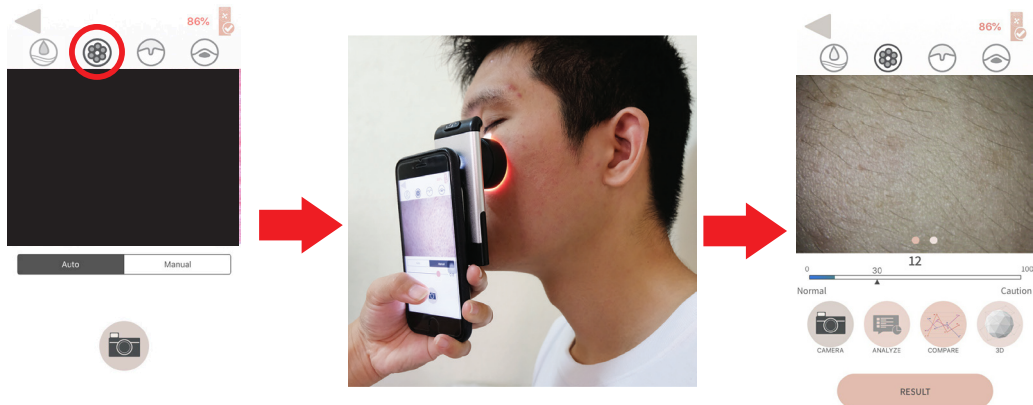

3. After taking the image, Press Analyze



Press Compare



Press 3D

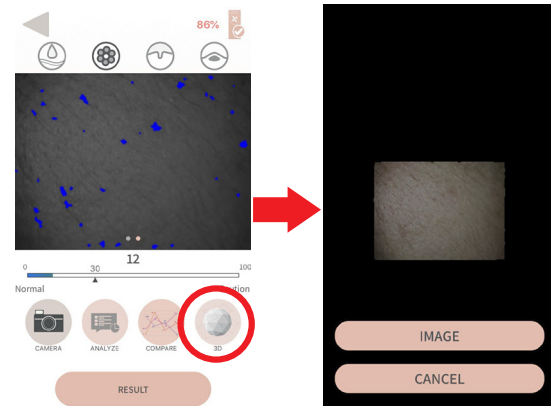

# HOW TO USE

## ANALYZING PORE, WRINKLE, AND IMPURITIES

4. Select the wrinkles icon. 
5. Put camera on the eye wrinkle area and take picture

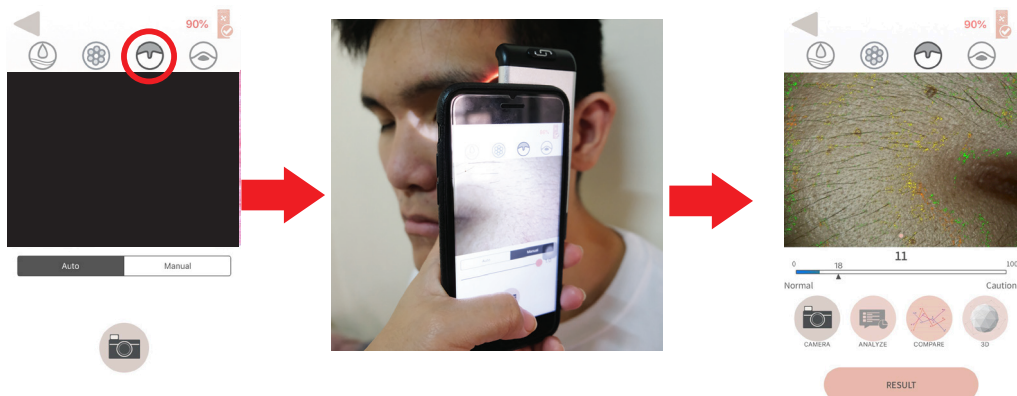

6. Press Analyze, Compare and 3D, same on Step 3.
7. Do the same steps to analyze Impurities. 
8. Press Result to see summary of all results.



# COMPARING RESULTS

## 2 OR MORE ANALYSIS RESULTS

1. Open main screen page
2. Press start, customer and choose customer name from list



3. Click the round pink icon on the right to view analysis results save

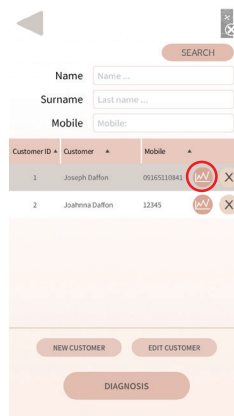

4. Select the dates you want to compare
5. Press compare button and view a linear graph of comparison

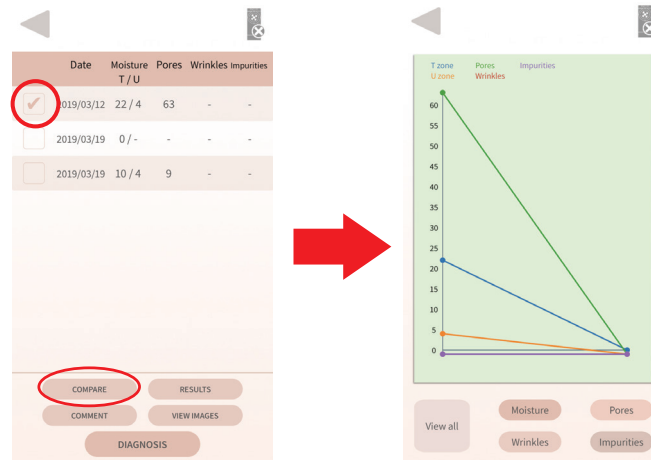

# ADDING PRODUCT RECOMMENDATION IMAGES

- 1. Go to the main page and open the settings button.
- 2. Press products and treatments.



- 3. Upload product images stored on the phone based on targeted skin measurements available for analysis.
- 4. When all fields are done, press Save

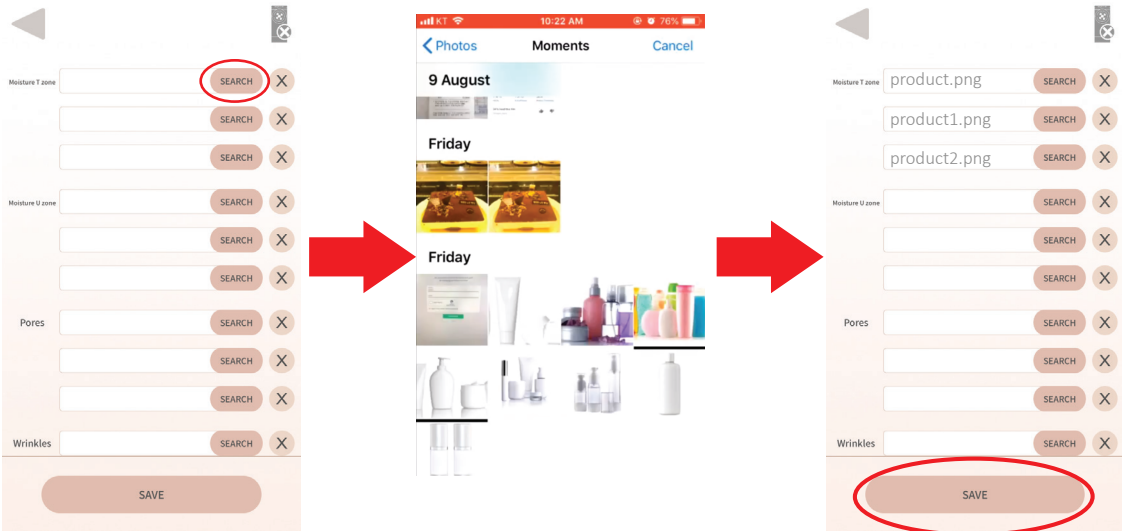

# RESULTS SHARING FUNCTION

1. After performing analysis, you can send results to your customer via the share function button (image)

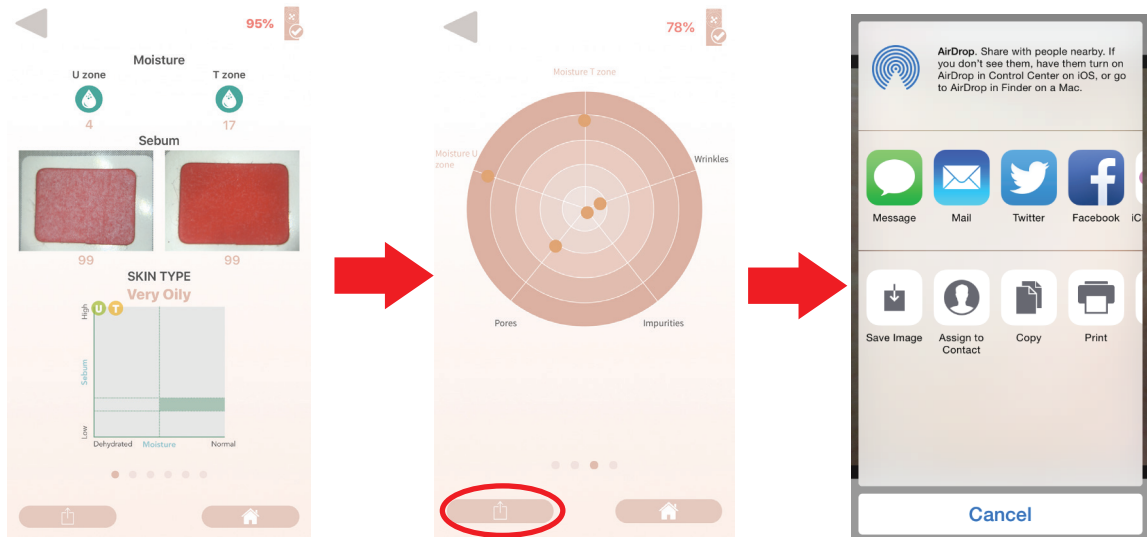

# LANGUAGE SETTINGS

1. On home page, select Settings then Change Language
2. Select the language desired and press Save.

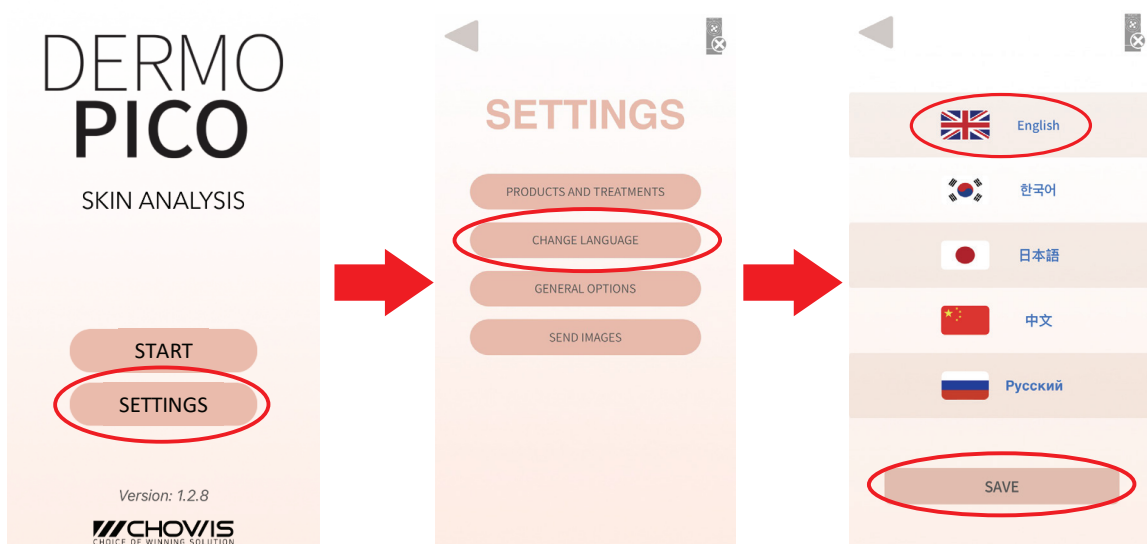

# SEND IMAGES BUTTON

1. On the Settings press Send images button
2. Press Center of the screen to allow users to send images to the Chowis servers.

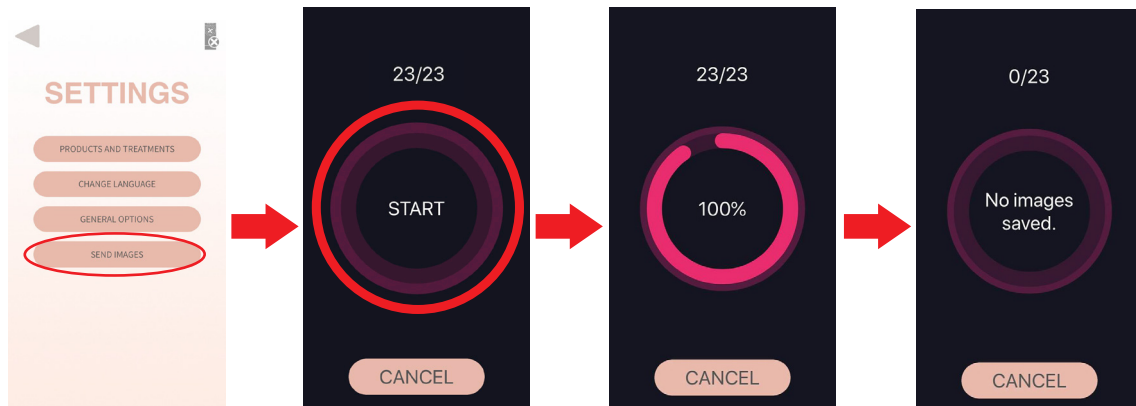

## FAQ

### How will I know if the device is turned on?

Device is turned on by doing a long press of the power button. You will notice that lights are well lit and stable. If you only see blinking lights when you click the power button, it means it is not yet turned on.

### How do I connect the device to the phone?

Yes you can as long as the app is installed. Connectivity is done thru BLE connection. Simply turn on Bluetooth to pair the device to the phone. A CMA address will appear upon opening the Dermopico app, click and connect.

### Will I be able to connect to the app without internet?

Yes you may pair the app with the device thru BLE but in order to send the analysis results, you need to be connected to the internet.



**Can I connect the device to multiple phones?**

**Where are the images stored?**

You can pair and use the dermopico to one phone at a time. All images taken by the device are stored on the phone's storage system. However, there is an option provided where images can be sent to Chowis server for analysis improvement purposes.

**Does dermo Pico work on Android and iOS?**

Yes, dermopico works with most IOS phones and Android version is on its final stages of development.

**How long can we use the device with a full battery?**



**How long should we charge it?**

Charging time is 2 hours maximum.

**Can I take sebum without sebum indicator?**

No, you cannot take sebum measurement without using the sebum indicator .

# SPECIFICATIONS

 Power supply	Input: 100-240-V / Output: 5V, 2A
 Magnification	10×
 Battery	250 lithium-ionbattery
 Product size	106 mm × 46 mm × 37 mm
 Product weight	60 g
 Analysis result	Index per measurement (0–99)
 Measurement	     hydration    wrinkle    pores    impurities    sebum

# CONTACT

Email: [hello@chowis.com](mailto:hello@chowis.com)

Skype ID: Hello Chowis

Chowis Co., Ltd.

Homepage:[www.chowis.com](http://www.chowis.com)

Tel: +82 31 706 7950 / Fax: +82 31 2727950

Address: 114, Sinbong 1-ro, Suji-gu, Yongin-si,  
Gyeonggi-do, Republic of Korea, 16814

